



1" Wall Mount Cylinder,  
Direct/Indirect



## Features

The FINCH family of cylinders with a 1" aperture, features exceptional output, flexibility, and a broad range of configurations to provide discreet quality illumination while integrating into the architecture. It is available in a fixed downlight, adjustable (with 50° tilt), wall mount and even exterior ground mount options. Whether installed on ceilings, walls/mullions or the ground, the FINCH family blends seamlessly into its surroundings.

The FINCH wall mount direct/indirect cylinder, 6" in length, offers up to 800 lm output for both direct and indirect, and has a choice of beveled front door options for additional shielding for the direct portion and a flush lens for the indirect portion, to prevent dirt accumulation.

## Product Overview

Type:	Wall Mount, Direct/Indirect
Wattage:	12W, 16W
Color Temp:	2400K, 2700K, 3000K, 3500K, 4000K
CRI:	80+ & 90+ typ.
Dimming:	0-10V, DALI, TRIAC/ELV

PROJECT:

TYPE:

## Performance Data

Direct		Indirect		Total	Total	CCT	CRI
Watts	Lumens	Watts	Lumens	Lumens	LPW		
6	643	6	643	1286	107.2	3000K	80+
8	787	8	787	1574	98.4	3000K	80+

Data is based on flood optics, 120V, 3000K, 80+ IES files available on website

## Electrical Data

	6W/6W		8W/8W	
	Watts	Amps	Watts	Amps
120V	12.6	0.108	16.8	0.142
277V	13.4	0.068	17.2	0.076

Electronic constant current LED driver



**PROJECT:**
**TYPE:**

To Order, please specify both the light fixture and remote driver.

Fixture Example: FIN6-WDI.6/6.309.WF/WF.BT.GLD.DB.RC.SOL

Remote Driver Example: FINPW.10.0-10V.RBX2

**1" Wall Mount Direct/Indirect (with Remote Driver) Ordering Information**

FIN6-WDI		/	.	/	.	/SBX	.	.	
1	2	3	4	5	6	7	8	9	
1	Model	2	Wattage	3	Color Temp and CRI	4	Beam Spreads	5	Body Finish
	<b>FIN6-WDI</b> 6" wall mount, direct/indirect	<b>6/6</b> 12W total <b>8/8</b> 16W total	<b>30</b> 3000K, 80+ <b>35</b> 3500K, 80+ <b>40</b> 4000K, 80+ <b>249</b> 2400K, 90+ <b>279</b> 2700K, 90+ <b>309</b> 3000K, 90+ <b>359</b> 3500K, 90+ <b>409</b> 4000K, 90+	<u>Direct</u> <b>SP</b> spot 15° <b>FL</b> flood 28° <b>WF</b> wide flood 35° <b>VWF</b> very wide flood 50° <u>Indirect</u> <b>SP</b> spot 15° <b>FL</b> flood 28° <b>WF</b> wide flood 35° <b>VWF</b> very wide flood 50°	<b>WT</b> white texture <b>BT</b> black texture <b>SLV</b> matte silver <b>BRZ</b> bronze <b>DBZ</b> dark bronze  <i>For custom RAL finish, consult factory</i>				
6	Bevel Finish	7	Door Style	8	Mounting	9	Accessories		
	<u>Direct</u> <b>MW</b> matte white <b>MB</b> matte black <b>SLV</b> matte silver <b>BRZ</b> bronze <b>DBZ</b> dark bronze  <i>For custom RAL finish, consult factory</i> <b>GLD</b> custom gold <u>Indirect</u> Finish to match body finish	<u>Direct</u> <b>SB</b> standard bevel (1/4" recess) <b>DB</b> deep bevel (5/8" recess) <u>Indirect</u> <b>SBX</b> standard bevel with flush lens	<b>MUL</b> mullion mount (Ø2") <b>C</b> canopy (Ø5") <b>RC</b> reduced canopy (Ø3-1/2") <b>CDC</b> conduit canopy (Ø4-1/8")	<b>SOL</b> solite lens <b>HEX</b> hexcell louver <b>LS</b> linear spread lens					

**Remote Driver Ordering Information**

Remote driver enclosures can be provided by others or can be specified below to your project requirements. Amerlux offers a mounting plate for each remote driver with accessories for mounting in enclosure by others, or a single remote box that can fit two drivers. Electrical Contractor (EC) is responsible for adherence to all local codes.

FINPW	.	.	.
<b>1</b>	<b>2</b>	<b>3</b>	<b>4</b>
1 Model	2 Wattage	3 Drivers/Controls	4 Driver Enclosure
<b>FINPW</b>	<b>6/6</b> 12W total <b>8/8</b> 16W total	<b>0-10V</b> 0-10V dimming, 1%, 120/277VAC <b>DALI</b> DALI dimming, 1%, 120/277VAC <b>LE/TE</b> TRIAC/ELV dimming, 5%, 120/277VAC	<b>RBX2</b> remote box (2 drivers) <b>MP</b> mounting plate <i>Note: One wattage &amp; dimming            protocol per box.</i>

For enclosure drawings &amp; wiring schematics, see pages 6-8.

**PROJECT:**
**TYPE:**
**Specifications**
**Application**

Retail, commercial and hospitality wall mounted accent lighting

**Construction**

Extruded aluminum precision machined body, door & heatsink

**Optical**

TIR optics

Beam Spreads: Spot 15°, Flood 28°, Wide Flood 35°,  
 Very Wide Flood 50°

**LED**

Color Temp: 2400K, 2700K, 3000K, 3500K, 4000K

CRI: 80+ & 90+ typ.

R9 Values: 11 (83 CRI), 55 (92 CRI)

Binning: 3 MacAdam (SDCM)

Life: 50,000+ hrs, > 70% of initial lumens at 50,000 hrs

**Finish**

Powder coat paint

*Consult factory for custom finishes*

**Mounting**

Wall mount

**Certifications**

CSA tested to UL standards

Indoor use only

Damp location

**Warranty**

5 year limited warranty

**Electrical**

**This product complies with IEEE C62.41 for surge endurance up to 2.5KV. Amerlux® recommends using additional surge protection with this unit (supplied by others), surge and over voltage damage is not covered under warranty.**

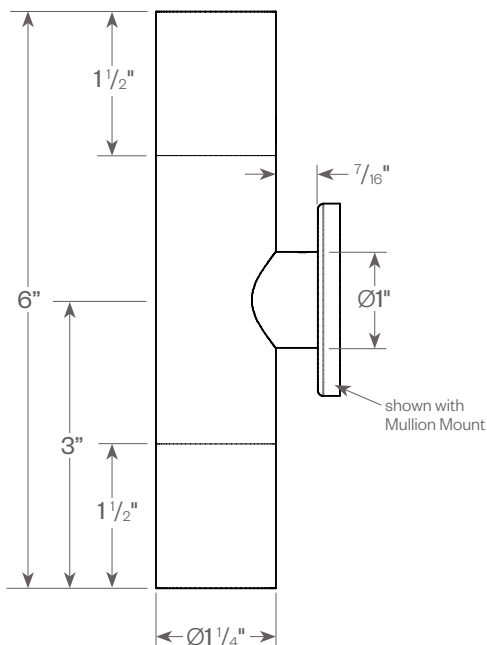
**FIN6-WDI**

**PROJECT:**
**TYPE:**

### Junction Box Mounting Requirements

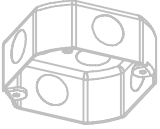

Canopy (C) & Conduit Canopy (CDC) Mounts  
 Require 4" Octagonal Junction Box (by others)

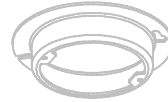

Reduced Canopy (RC) Mounts also  
 Require Raised Cover (by others) for  
 4" Octagonal Junction Box

### Mounting Options

Mullion Mount

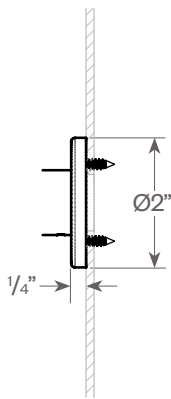

Canopy Mount

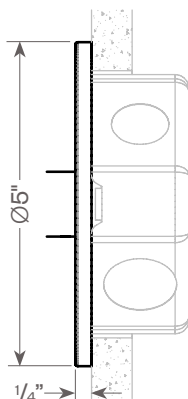

Reduced Canopy Mount

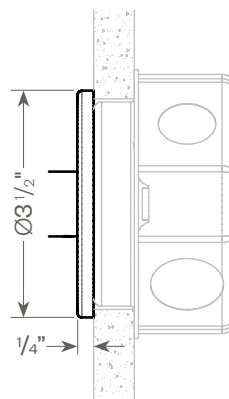

Conduit Canopy Mount

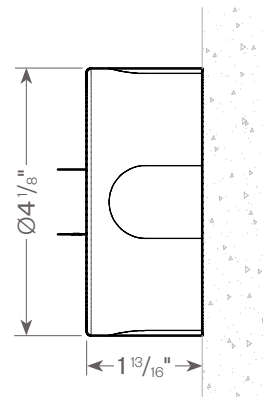

### Door Styles

Direct

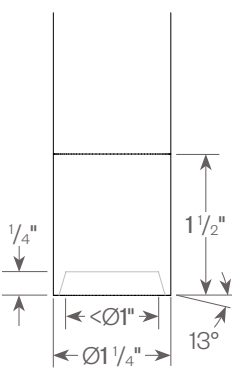

Standard Bevel (SB)

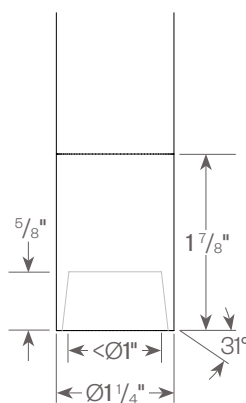
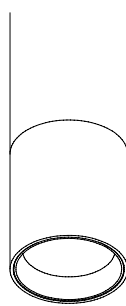

Deep Bevel (DB)

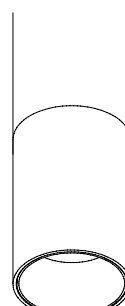

Indirect

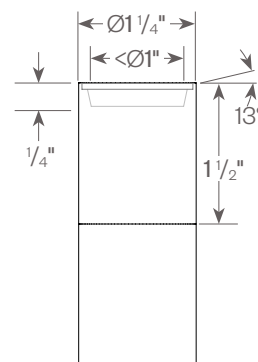

Standard Bevel with flush lens (SBX)

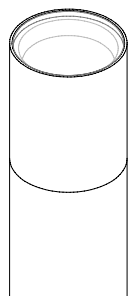

### Finish Options

Powder coat paint.  
 Consult factory for custom finishes.



Matte Black



Matte White



Matte Silver

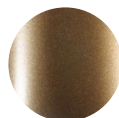

Bronze

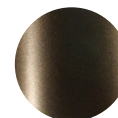

Dark Bronze



Black Texture



Custom Gold

Available for Bevel Finish only

**PROJECT:**
**TYPE:**
**Fixture Data**
**MULTIPLYING FACTORS:**

Wattage:	6W	8W	20W*
Factor:	0.44	0.54	1.0

\* Multiplying factors based on IES 20W tested fixture.  
 20W is not available for this fixture type.

CCT:	3000K, 80+	3500K, 80+	4000K, 80+	2400K, 90+	2700K, 90+	3000K, 90+	3500K, 90+	4000K, 90+
Factor:	1.0	1.04	1.06	0.76	0.83	0.88	0.92	0.93

Multiplying Factor is based on 3000K, 80+ 120V IES file on website.

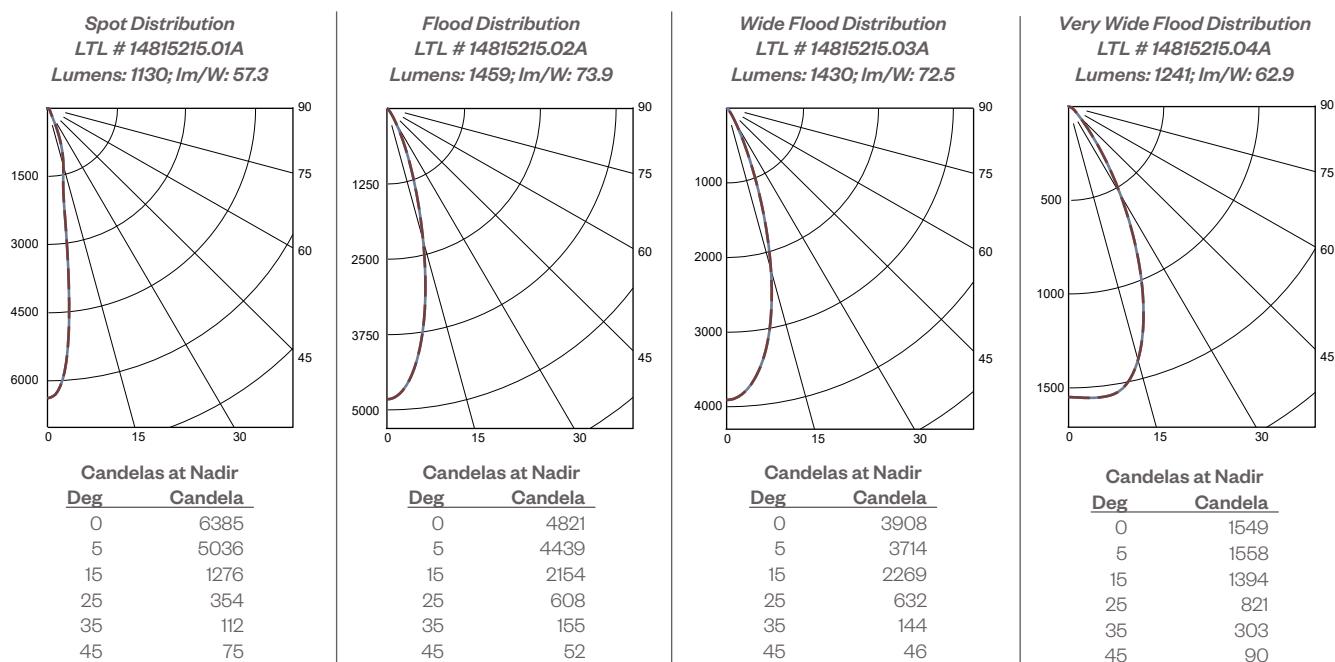
**20W, Direct, Standard Bevel, 3000K, 80+**

**Application Data:**
**Notes and Definitions:**

Beam spread is to 50% center beam candlepower (CBCP).

D=Distance to floor or wall.

FC=Footcandles on floor or wall at center beam aiming location.

L=Effective Visual Beam length in feet (50% of maximum footcandle level).

W=Effective Visual Beam width in feet (50% of maximum footcandle level).

CB=Distance across or down to center beam location.

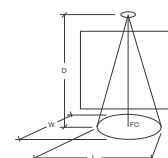

**Spot**

0° Aiming Angle  
Horizontal  
Footcandles



D	FC	L	W
5.0'	158	1.9	1.9
7.5'	91	2.5	2.5
10.0'	57	3.0	3.0
12.5'	38	3.5	3.5

**Flood**

0° Aiming Angle  
Horizontal  
Footcandles



D	FC	L	W
5.0'	178	2.6	2.6
7.5'	85	3.6	3.6
10.0'	49	4.7	4.7
12.5'	31	5.8	5.8

**Wide Flood**

0° Aiming Angle  
Horizontal  
Footcandles



D	FC	L	W
5.0'	138	3.0	3.0
7.5'	66	4.3	4.3
10.0'	38	5.6	5.6
12.5'	25	7.0	7.0

**Very Wide Flood**

0° Aiming Angle  
Horizontal  
Footcandles



D	FC	L	W
5.0'	61	4.2	4.2
7.5'	27	6.3	6.3
10.0'	16	8.4	8.4
12.5'	10	10.6	10.6

**PROJECT:**

**TYPE:**

### Power Supply Options for Remote Driver

#### Remote Box (RBX2)

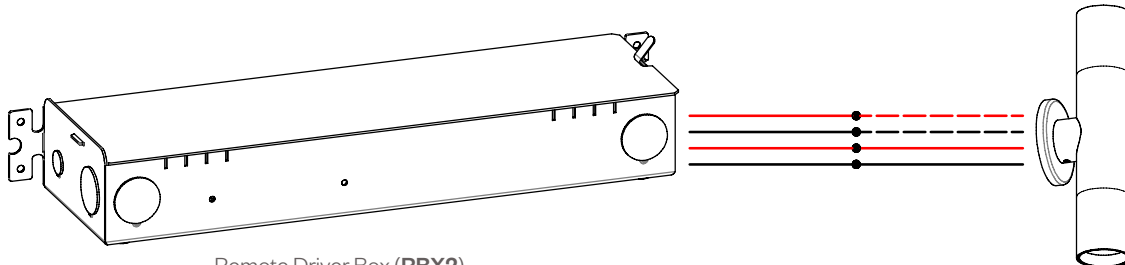

Remote Driver Box (**RBX2**)  
(1 per 2 drivers)  
15-11/16" x 4-5/16" x 2-7/16"

#### Mounting Plate (MP)

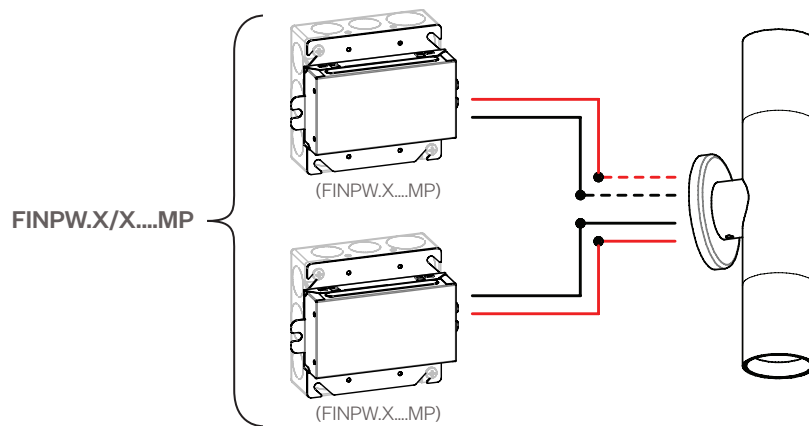

Remote Driver with Mounting Plate (**MP**)  
4" Square Junction Box (by others)

**PROJECT:**
**TYPE:**
**DIMMING COMPATIBILITY:**

Amerlux® Finch fixtures are compatible with all major dimming protocols prevalent in the United States. Please see below for general compatibilities and wiring diagrams. Amerlux recommends testing your unique dimming configuration as the exact full configuration (Dimmer, Fixture Quantity, Voltage, etc) may affect dimming performance.

**--- NOTE: INFORMATION BELOW IS FOR WIRED DIMMERS ONLY. FOR WIRELESS DIMMERS, CONSULT FACTORY ---**

**FOR REMOTE DRIVER OPTION**
**0-10V - DIMMING**

Integrates into a variety of building management and daylighting controls

**Notes:**

- 120VAC or 277VAC
- Dims down to 1% light output
- Requires interface to turn off power to driver
- Consult Dimming manufacturer for installation instructions - DO NOT SHARE NEUTRALS!

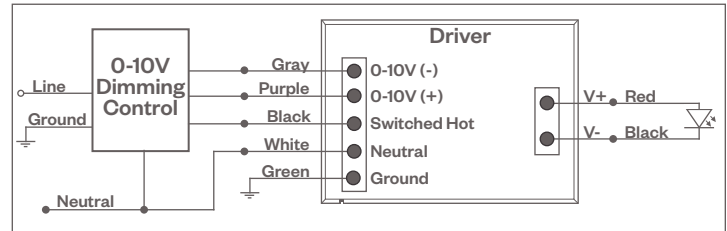
**0-10V Wiring Diagram**

**Compatible Dimmers\*:**
**Wall Box**

Lutron "Diva" - DVSTV

Leviton Renoir II 0-10V

**Central System**

Lutron Grafik Eye with GRX-TVI Interface

**DALI DIMMING**

Digital control protocol allows individual fixture control

**Notes:**

- 120VAC or 277VAC
- Dims down to 1% light output in most cases

**Compatible Dimmers\*:**
**Wall Box (3-Wire Fluorescent)**

Leviton CD250 Controller

**Central System**

Dynalite  
Fifth Light

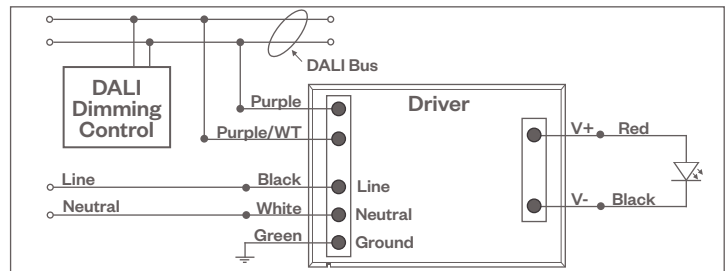
**DALI Wiring Diagram**

**TRIAC (Forward Phase) DIMMING (Standard)**

Utilizes standard TRIAC dimmers that are in wide use in installations across the US. Best for retrofit applications where TRIAC dimmers are installed.

**Notes:**

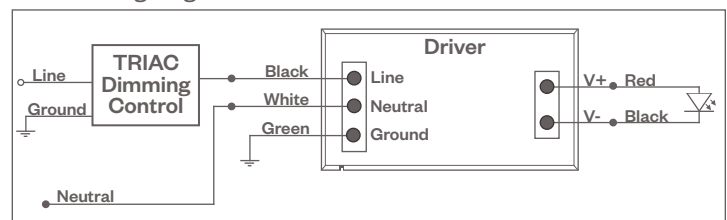
- 120VAC or 277VAC\*
- Dims down to 5% light output (most cases)
- Consult Dimming manufacturer for installation instructions - DO NOT SHARE NEUTRALS!
- Must meet dimmer Minimum Load Requirements per dimming manufacturer

**TRIAC Wiring Diagram**

**Compatible Dimmers\*:**
**Wall Box (TRIAC 120VAC)**

Lutron "Diva"

Lutron "Nova-T"

Lutron "Maestro"

Lutron "Skylark"

**Central System**

Lutron "GP" Panel

Lutron Grafik Eye QS

**Notes:**

\* Driver is 277VAC dimmable with appropriate dimmer (by others). All provided wiring diagrams show 120VAC wiring colors and method.

Please refer to 277VAC dimmer manufacturer installation instructions for 277VAC wiring diagrams.

\* The absence of a dimmer from the lists above does not imply incompatibility. Please consult factory for compatibility inquiries.

**PROJECT:**
**TYPE:**
**DIMMING COMPATIBILITY:**

Amerlux® Finch fixtures are compatible with all major dimming protocols prevalent in the United States. Please see below for general compatibilities and wiring diagrams. Amerlux recommends testing your unique dimming configuration as the exact full configuration (Dimmer, Fixture Quantity, Voltage, etc) may affect dimming performance.

**--- NOTE: INFORMATION BELOW IS FOR WIRED DIMMERS ONLY. FOR WIRELESS DIMMERS, CONSULT FACTORY ---**

**FOR REMOTE DRIVER OPTION**
**ELV - Electronic Low Voltage (Reverse Phase) DIMMING**

Utilizes specialized "ELV" dimmers.

**Notes:**

- 120VAC or 277VAC\*
- Dims down to 5% light output (most cases)
- Consult Dimming manufacturer for installation instructions - DO NOT SHARE NEUTRALS!
- Must meet dimmer Minimum Load Requirements

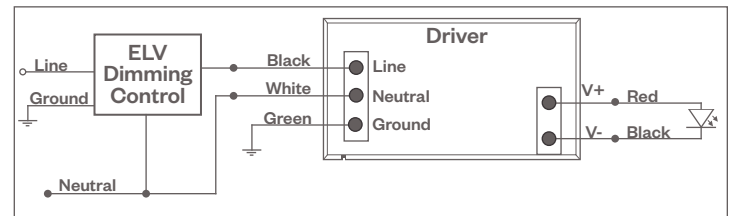
**ELV Wiring Diagram**

**Compatible Dimmers†:**
**Wall Box (ELV 120VAC)**

Lutron "Diva"  
 Lutron "Nova-T"  
 Lutron "Maestro"  
 Lutron "Skylark"  
 Leviton "Surslide"  
 Leviton "Vizio"

**Wall Box (ELV 277VAC)**

Leviton Revoir II AWSMT-E

**Central System**

Lutron "GP" Panel with PHPM-PA 120/277VAC  
 Lutron Grafik Eye QS with PHPM-PA 120/277VAC

**Notes:**

\* Driver is 277VAC dimmable with appropriate dimmer (by others). All provided wiring diagrams show 120VAC wiring colors and method. Please refer to 277VAC dimmer manufacturer installation instructions for 277VAC wiring diagrams.

† The absence of a dimmer from the lists above does not imply incompatibility. Please consult factory for compatibility inquiries.