

Acion

Small Wall-Mount LED Accent

WMACCS / BLK

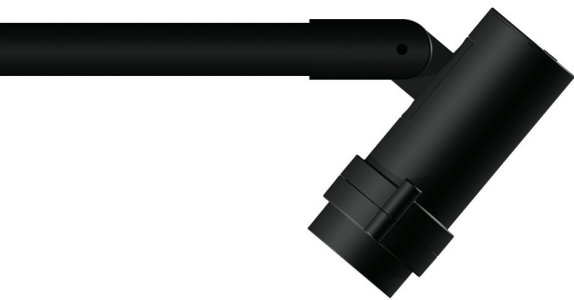

Features

The Amerlux Accent luminaire employs solid state technology and precision engineering to provide small scale LED solutions in landscape and architecture layouts. All components are encapsulated inside a single attractive enclosure designed for superior performance in weather resistant applications. Offered in a choice of beam spreads, finishes, and color temperatures, two mounting options and glare shield are also available.

Product Overview

Wattage:	10W
Lumen Output:	710 lm
Color Temp:	2,700K / 3,000K / 3,500K
Dimming:	ELV at 120v only

PROJECT:

TYPE:

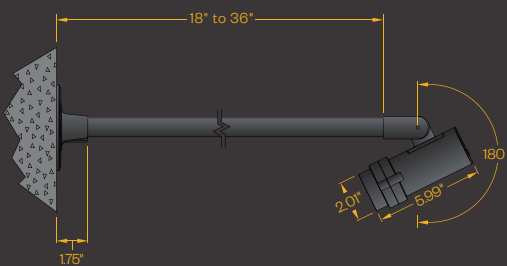

Construction:

- Die-cast aluminum
- IP67 sealed optical chamber and integral driver chamber
- Easy "two-screw" integral driver access, does not disturb optical chamber seal
- Flush lens prevents puddles/water deposits in upward facing applications
- Yoke mount or Knuckle mount available
- Vertical aiming lock, with tamper-resistant tooled locking after final aiming

Optics:

- Lumen maintenance: 70% @ 50,000 hours
- 10°, 15°, 30°, 40°, 60°, 60x10, 60x30, 90x60 beam spreads are available with secondary shaping lens

Electrical:

Integral driver
 Input voltage 120v-277v auto-sensing
 1/2" NPSM wire entry
 Drive current 700mA
 Power consumption 10W
 ELV dimmable at 120v only

ETL listed, suitable for wet locations.

Optical Accessories:

- Hexell Louver (HCS)
- Half Glare Shield (HGS)

Finish:

Premium quality thermoset polyester powdercoat for a durable finish.

BLK -Satin Black
CLB -Classic Bronze

GRN -Green
CSTM -Custom

PROJECT:

TYPE:

Optical Accessories:

HGS
(Glare Shield)

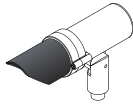

HCS
(Hexell Louver)

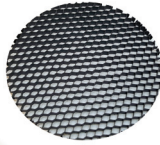

Mounting Plate:

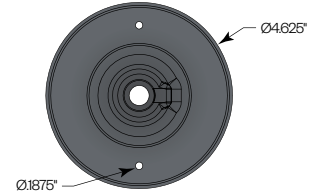

Optical Performance:

Polar Graph
ACCS / 27K / 10

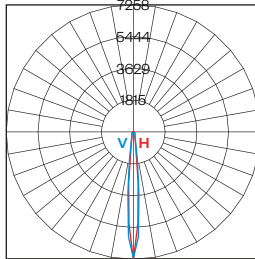

Maximum Candela = 7258
Horizontal Beam Angle (50%) 11
Vertical Beam Angle (50%) 11
Horizontal Field Angle (10%) 21
Vertical Field Angle (10%) 22

Polar Graph
ACCS / 27K / 30

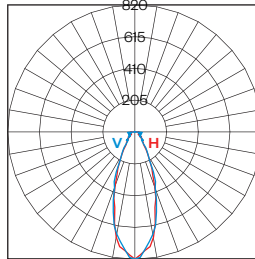

Maximum Candela = 820
Horizontal Beam Angle (50%) 38
Vertical Beam Angle (50%) 36
Horizontal Field Angle (10%) 77
Vertical Field Angle (10%) 76

Polar Graph
ACCS / 27K / 40

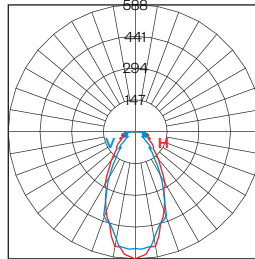

Maximum Candela = 588
Horizontal Beam Angle (50%) 47
Vertical Beam Angle (50%) 46
Horizontal Field Angle (10%) 92
Vertical Field Angle (10%) 130

Polar Graph
ACCS / 27K / 60

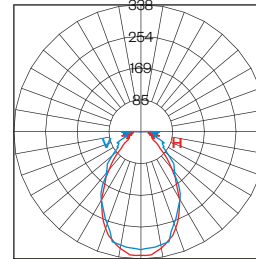

Maximum Candela = 338
Horizontal Beam Angle (50%) 70
Vertical Beam Angle (50%) 66
Horizontal Field Angle (10%) 148
Vertical Field Angle (10%) 142

Polar Graph
ACCS / 27K / 60X10

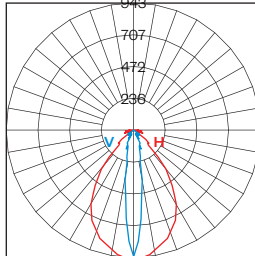

Maximum Candela = 943
Horizontal Beam Angle (50%) 66
Vertical Beam Angle (50%) 18
Horizontal Field Angle (10%) 98
Vertical Field Angle (10%) 52

Polar Graph
ACCS / 27K / 60X30

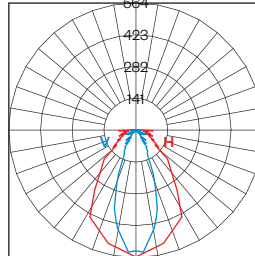

Maximum Candela = 564
Horizontal Beam Angle (50%) 65
Vertical Beam Angle (50%) 35
Horizontal Field Angle (10%) 115
Vertical Field Angle (10%) 99

Polar Graph
ACCS / 27K / 90X60

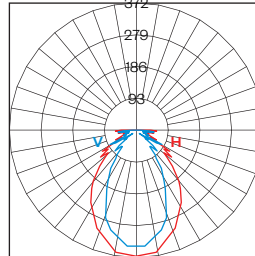

Maximum Candela = 372
Horizontal Beam Angle (50%) 78
Vertical Beam Angle (50%) 56
Horizontal Field Angle (10%) 152
Vertical Field Angle (10%) 142

Data represents the use of light shaping filters
Complete photometric data (ies format) available upon request

Ordering Information

Model	CCT	Beam Spread	Approx. Lumens	Total Efficacy	Mounting	Finish	Optical Accessories	Arm Length		
WMACCS	27 (2,700K) 30 (3,000K) 35 (3,500K)	Symmetric Pattern	10 (10°)	630-710	63-71 lm/W	K (Knuckle)	BLK CLB GRN CSTM	HCS HGS	18" 24" 36"	
			15 (15°)	600-680	60-68 lm/W					
			30 (30°)	570-650	57-65 lm/W					
			40 (40°)	570-650	57-65 lm/W					
			60 (60°)	540-620	54-62 lm/W					
		Horizontal Pattern	H6010 (60x10)	630-570	63-57 lm/W					
			H6030 (60x30)	570-590	57-59 lm/W					
			H9060 (90x60)	580-610	58-61 lm/W					
			Vertical Pattern	V6010 (60x10)	630-570					63-57 lm/W
				V6030 (60x30)	570-590					57-59 lm/W
		V9060 (90x60)	580-610	58-61 lm/W						

Ordering options shown as **BOLD**. Example: **WMACCS/30/10/K/BLK**