

EVOKE 2.9 ROUND DOWNLIGHT TRIMLESS

E2.9RDTL
T4GU6.5

APPLICATION:

Commercial and retail ambient and task lighting

HOUSING CONSTRUCTION:

20 ga. steel painted matte black
Formed aperture plate with 5/8" lip (GB-standard)
Cast aluminum plaster frame with perforated face
Integral adjustable locking mounting bars
Thermally protected
GU6.5 TAL pulse rated socket

REFLECTOR CONSTRUCTION:

Spun aluminum reflector
Variety of anodized aperture finishes

LAMPING:

CMH T4GU6.5 base, 15w (SYLVANIA METALARC® POWERBALL®), 20w and 39w

OPTICS:

Die-cast lamp housing, with twist in/out lens holder
Spun faceted & peened optics, specially designed for T4GU6.5 lamps
Accepts up to 2 accessories
Available in custom tints to tune beam to provide incandescent-like hue

MOUNTING:

For use in sheet rock ceilings
Max. ceiling thickness 1"

LABELING:

 US
Damp location



PROJECT:

TYPE:

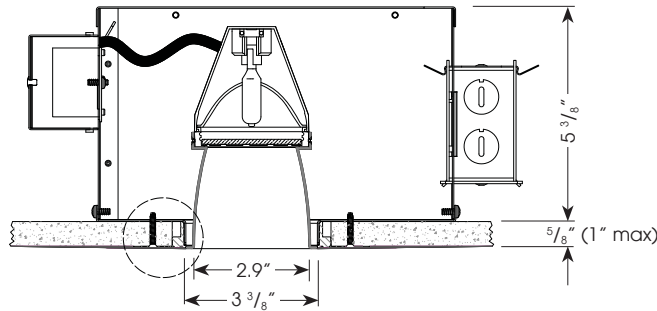
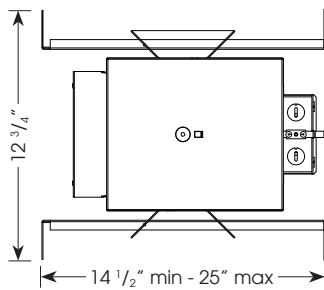

Ceiling Cut Out Dimension: 4 1/16" dia.

ELECTRICAL

Ballast	15w		20w		39w	
	Input Watts	Amps*	Input Watts	Amps*	Input Watts	Amps*
Electronic 120v	18	.15	24	.20	45	.40
277v	18	.07	24	.09	45	.16

*data is for open circuit current
CMH T4GU6.5 base metal halide, 15w, 20w and 39w
Electronic ballast

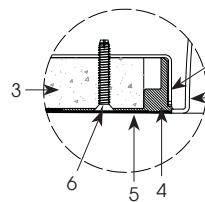

1. Reflector Trim
2. Fixture Housing Aperture Plate
3. Ceiling 5/8" (1" max)
4. Cast Aluminum Plaster Frame
5. Plaster Skim Coat (by others)
6. 6-32 Type F Thread Cutting Screw

ORDERING INFORMATION:

Housing						Reflector		Accessories Ordered Separately
Model	Wattage	Lamp Type	Voltage	Beam Spread	Optic Options	Model	Aperture Finish	
E2.9RDTL	15	T4GU6.5	120	CL - spot, 12°	GOLD - ferric gold optic reflector	E2.9RDTL	Reflector with Clear Flange (3/16" flange finish matches cone finish)	HEX20 - hexcell louver
	20		277	NF - narrow flood, 18°	DB2690 - DB2690 optic reflector		SDC - semi-diffuse	SOL20 - beam softening lens (standard w/NF option)
	39			FL - flood, 25°			CLC - specular	
				WF - wide flood, 40°			GDC - specular gold	
				SL - linear spread, 5° x 55°			BKC - specular black	SPR20 - linear spread lens, 5° x 55° (standard w/SL beam spread)

Complete Unit Specification: E2.9RDTL-20-T4GU6.5-120-NF/E2.9RDTL-SDC

Housing Only: E2.9RDTL-20-T4GU6.5-120-NF

Reflector Only: E2.9RDTL-SDC

Cat #:

Amerlux reserves the right to change details that do not affect overall function and performance.

EVOKE 2.9 ROUND DOWNLIGHT TRIMLESS

E2.9RDTL
T4GU6.5

amerlux
GLOBAL LIGHTING SOLUTIONS

TYPE:



FIXTURE DATA: Test run with standard clear reflector. For gold multiply by 0.9
For 15w data multiply by .75; For 39w data multiply by 2.1

Complete photometric data (ies format) available upon request.

20W T4GU6.5

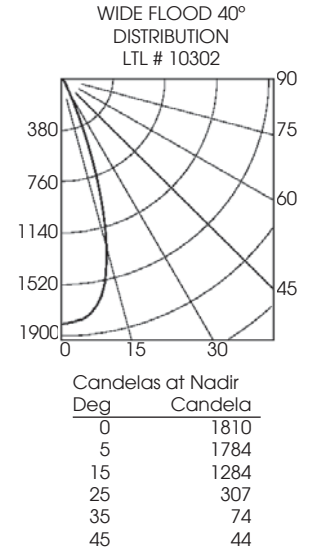
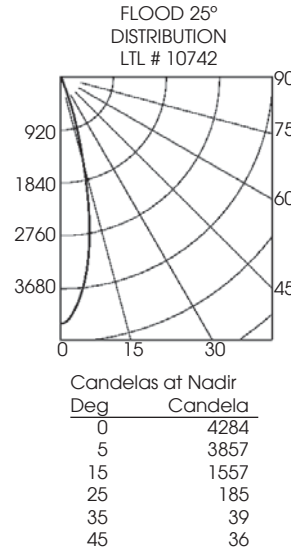
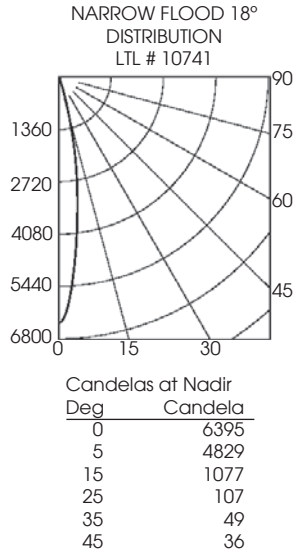
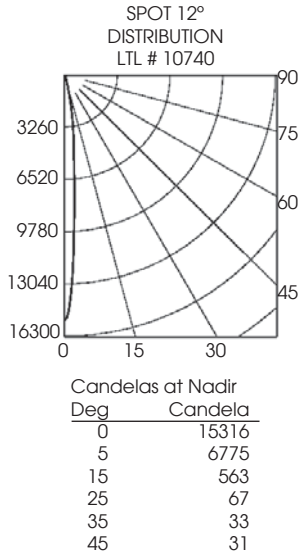

APPLICATION DATA:

Notes and Definitions:

Beam spread is to 50% center beam candlepower (CBCP).
D=Distance to floor or wall.
FC=Footcandles on floor or wall at center beam aiming location.
L=Effective Visual Beam length in feet (50% of maximum footcandle level).
W=Effective Visual Beam width in feet (50% of maximum footcandle level).
CB=Distance across or down to center beam location.

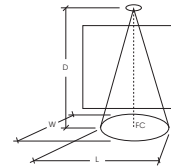

	D	FC	L	W
SPOT	5.0'	613	1.1	1.1
	7.5'	272	1.4	1.4
	10.0'	153	1.6	1.6
	12.5'	98	1.9	1.9
NARROW FLOOD	5.0'	256	1.5	1.5
	7.5'	114	2.3	2.3
	10.0'	64	3.1	3.1
	12.5'	41	3.8	3.8
FLOOD	5.0'	171	2.3	2.3
	7.5'	76	3.2	3.2
	10.0'	43	4.4	4.4
	12.5'	27	5.4	5.4
WIDE FLOOD	5.0'	72	3.1	3.1
	7.5'	32	4.7	4.7
	10.0'	18	6.3	6.3
	12.5'	12	7.8	7.8