

# EVOKE 2.9 ROUND DOWNLIGHT TRIMLESS

**E2.9RDTL**  
MR16

**APPLICATION:**

Commercial and retail ambient and task lighting

**HOUSING CONSTRUCTION:**

20 ga. steel painted matte black  
Formed aperture plate with 5/8" lip  
Cast aluminum plaster frame w/plaster face  
Integral adjustable locking mounting bars  
Thermally protected  
Bi-Pin base

**REFLECTOR CONSTRUCTION:**

Spun aluminum self flanged reflector  
Variety of anodized aperture finishes

**OPTICS:**

Die-cast lamp housing, with steel lamp retaining clip  
Clear lens  
Accepts up to 2 accessories  
Solite beam softening lens (standard)

**MOUNTING:**

For use in sheet rock ceilings  
Max. ceiling thickness 1"

**LABELING:**

 **UL** us  
Damp location

**LAMPING:**

MR16 halogen, 50w max., 12v.



PROJECT:  
  
TYPE:

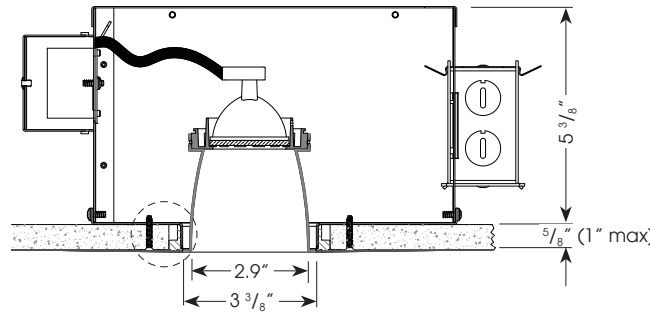
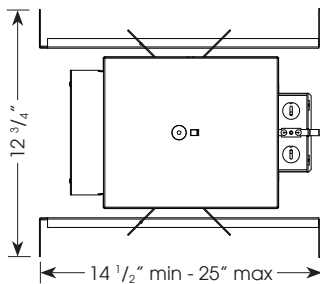

Ceiling Cut Out Dimension: 4 1/16" dia.

**ELECTRICAL**

| Ballast    | Input | Lamping |       |
|------------|-------|---------|-------|
|            |       | Watts   | Amps* |
| Electronic | 120v  | 50      | .42   |
|            | 277v  | 50      | .18   |

MR16 Bi-Pin base, 50w max.  
**Electronic ballast**

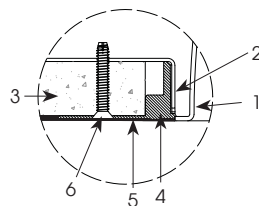

1. Reflector Trim
2. Fixture Housing Aperture Plate
3. Ceiling 5/8" (1" max)
4. Cast Aluminum Plaster Frame
5. Plaster Skim Coat (by others)
6. 6-32 Type F Thread Cutting Screw

**ORDERING INFORMATION:**

| Housing  |                   |            | Reflector |   | Accessories<br>Ordered Separately                                 |
|----------|-------------------|------------|-----------|---|---|
| Model    | Lamp Type         | Voltage    | Model     | Aperture Finish   |   |
| E2.9RDTL | MR16<br>(50w max) | 120<br>277 | E2.9RDTL  | Reflector with Clear Flange<br>(3/16" flange finish matches cone finish)<br>SDC - semi-diffuse<br>CLC - specular<br>GDC - specular gold<br>BKC - specular black | HEX16 - hexcell louver<br>SPR16 - linear spread<br>lens, 5° x 55° |

Complete Unit Specification: E2.9RDTL-MR16-120/E2.9RDTL-SDC  
Housing Only: E2.9RDTL-MR16-120  
Reflector Only: E2.9RDTL-SDC

Cat #:

Amerlux reserves the right to change details that do not affect overall function and performance.

# EVOKE 2.9 ROUND DOWNLIGHT TRIMLESS

E2.9RDTL  
MR16

**amerlux**  
GLOBAL LIGHTING SOLUTIONS

TYPE:



**FIXTURE DATA:**

Complete photometric data (ies format) available upon request.

**50W MR16**

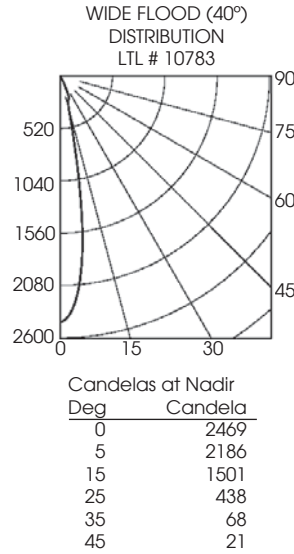
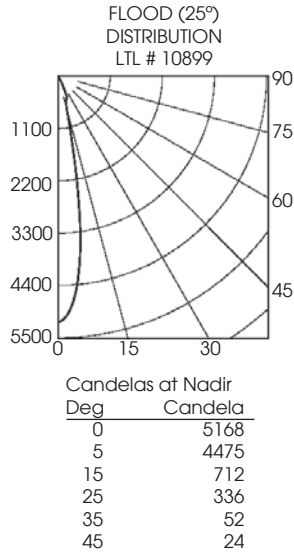
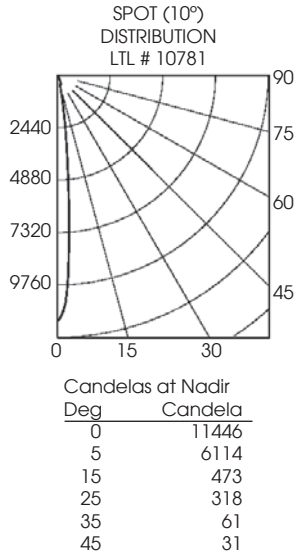

**APPLICATION DATA:**

**Notes and Definitions:**

Beam spread is to 50% center beam candlepower (CBCP).  
 D=Distance to floor or wall.  
 FC=Footcandles on floor or wall at center beam aiming location.  
 L=Effective Visual Beam length in feet (50% of maximum footcandle level).  
 W=Effective Visual Beam width in feet (50% of maximum footcandle level).  
 CB=Distance across or down to center beam location.

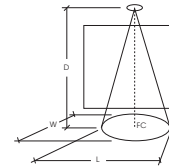

|            | D     | FC  | L   | W   |
|------------|-------|-----|-----|-----|
| SPOT       | 5.0'  | 458 | 1.1 | 1.1 |
|            | 7.5'  | 204 | 1.4 | 1.4 |
|            | 10.0' | 115 | 1.8 | 1.8 |
|            | 12.5' | 73  | 2.4 | 2.4 |
| FLOOD      | 5.0'  | 207 | 1.5 | 1.5 |
|            | 7.5'  | 92  | 2.6 | 2.6 |
|            | 10.0' | 52  | 3.3 | 3.3 |
|            | 12.5' | 33  | 4.1 | 4.1 |
| WIDE FLOOD | 5.0'  | 99  | 2.9 | 2.9 |
|            | 7.5'  | 44  | 4.4 | 4.4 |
|            | 10.0' | 25  | 6.0 | 6.0 |
|            | 12.5' | 16  | 7.5 | 7.5 |