

EVOKE 2.9" SQUARE LENS WALL WASH TRIMLESS

E2.9SLWTL
PAR20 MH

APPLICATION:

Commercial and retail wall wash lighting

HOUSING CONSTRUCTION:

20 ga. steel painted matte black
Formed aperture plate with 3/8" lip
cast aluminum plaster frame w/perforated face
Integral adjustable locking mounting bars
Thermally protected
Medium base pulse rated socket

OPTICS:

Formed steel lamp holder

REFLECTOR CONSTRUCTION:

Die-cast aluminum seamless trim
Painted finishes include matte white and optical matte black
Linear spread lens with etched finish on interior side

MOUNTING:

For use in T-grid or sheet rock ceilings
Max. ceiling thickness - 1"

LABELING:

cUL listed
Damp location

LAMPING:

PAR20MH medium base, 20w and 39w



PROJECT :

TYPE :

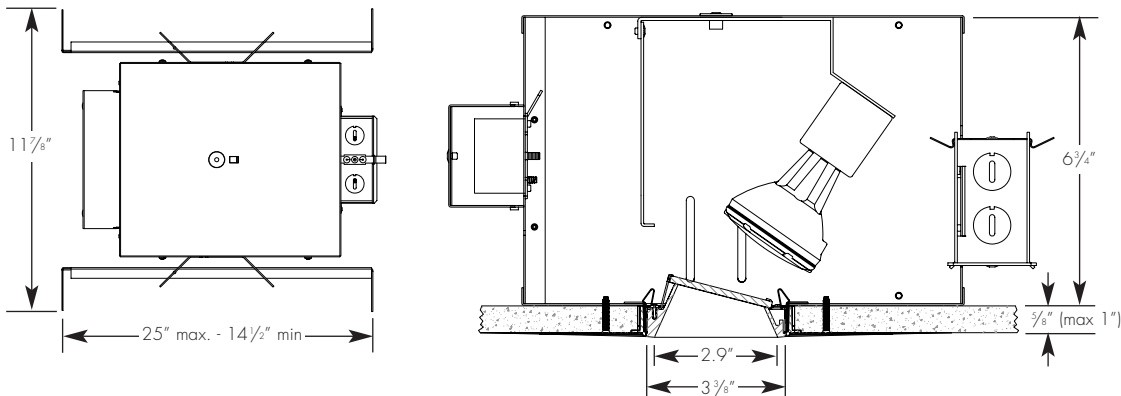

Ceiling cut out dimension: 4 1/8" sq.

ELECTRICAL

Ballast	Input volts	Lamping		Input volts	Amps*
		20w	39w		
Electronic	120v	24	.20	45	.40
	277v	22	.09	44	.16

*Data is for open circuit current
PAR20MH medium base, 20w and 39w

Electronic ballast

Amerlux reserves the right to change details that do not affect overall function and performance.

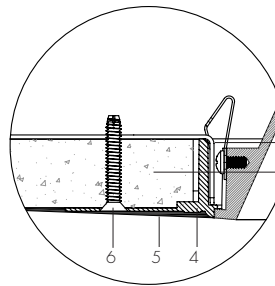

1. Reflector Trim
2. Fixture Housing Aperture Plate
3. Ceiling 5/8" (1" Max.)
4. Cast Aluminum Plaster Frame
5. Plaster Skim Coat (By Others)
6. 6-32 Type F Thread Cutting Screw

ORDERING INFORMATION:

HOUSING				REFLECTOR	
Model #	Wattage	Lamp Type	Voltage	Model #	Aperture Finish
E2.9SLWXTL	20	PAR20MH	120	E2.9SLWTL	Reflector (with 3/16" flange)
	39		277		MB - matte black
					MW - matte white

ecotECTURAL
Architectural lighting for sustainable design.



Complete Unit Specification: E2.9SLWXTL-39-PAR20MH-120/E2.9SLW-MW
Housing Only: E2.9SLWXTL-39-PAR20MH-120
Reflector Only: E2.9SLWTL-MW

Cat #:

EVOKE 2.9" SQUARE LENS WALL WASH TRIMLESS

E2.9SLWTL
PAR20 MH



TYPE :

ecOTECTORAL
Architectural lighting for sustainable design.



FIXTURE DATA:

Complete photometric data (.ies format) available upon request.

Evoke 2.9" Square Lens Wall Wash Trimless
Lamp: Philips CDM35/PAR20/M/FL Lamp Lumens: 2000
Recessed

ZONAL LUMEN SUMMARY

Zone	Lumens	%Lamp	%Fixt
0-30	130	6.5	31.9
0-40	238	11.9	58.1
0-60	380	19.0	92.7
0-90	410	20.5	100.0
90-180	0	0.0	0.0
0-180	410	20.5	100.0

Total Luminaire Efficiency = 20.5%

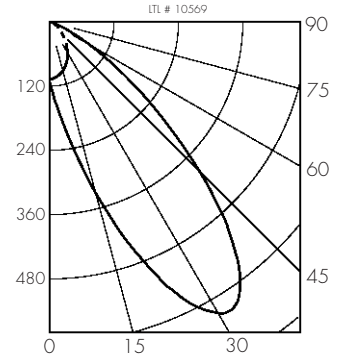

APPLICATION DATA:

Footcandles on Wall

Footcandles are average and rounded off.
Data for multiple units are based on a minimum of five units.

1.5 Feet From Wall

Distance From Ceiling	1'	35.0	35.0	39.8
1'	39.9	35.0	35.0	39.8
2'	78.3	74.6	74.7	78.7
3'	41.4	41.2	41.5	42.5
4'	19.6	20.0	20.2	20.6
5'	10.1	10.4	10.6	10.8
6'	5.8	6.0	6.1	6.2
7'	3.6	3.7	3.8	3.8
8'	2.3	2.4	2.5	2.5

1.5 Feet From Wall

Distance From Ceiling	1'	10.3	8.3	10.3	11.8
1'	11.8	10.3	8.3	10.3	11.8
2'	36.3	35.2	32.9	35.2	36.3
3'	31.8	31.7	30.7	31.7	31.8
4'	20.6	20.5	20.2	20.5	20.6
5'	12.9	12.7	12.6	12.7	12.9
6'	8.3	8.2	8.1	8.2	8.3
7'	5.5	5.5	5.5	5.5	5.5
8'	3.9	3.9	3.9	3.9	3.9

2 Feet From Wall

Distance From Ceiling	1'	3.8	3.5	3.8	4.0
1'	4.0	3.8	3.5	3.8	4.0
2'	19.2	19.0	18.6	19.0	19.2
3'	27.5	26.9	26.8	26.9	27.5
4'	23.9	23.4	23.4	23.4	23.9
5'	17.4	17.1	17.1	17.1	17.4
6'	12.0	11.8	11.9	11.8	12.0
7'	8.3	8.2	8.3	8.2	8.3
8'	5.9	5.8	5.9	5.8	5.9