

EVOKE 2.9" INSULATED CEILING

ROUND LENS WALL WASH TRIMLESS

E2.9RICATTL/
E2.9RLWTL
MR16

APPLICATION:

Residential wall wash lighting

HOUSING CONSTRUCTION:

0.050 aluminum and 20 ga. steel housing
Powder coat matte black
Formed aperture plate with 1/2" lip
Cast aluminum plaster ring with perforated flange
Adjustable mounting bars for (wood) joist construction
Thermally protected
GX5.3 Bi-Pin base

REFLECTOR CONSTRUCTION:

Spun aluminum reflector with bias cut.
Available in a variety of finishes
Integral formed textured kick reflector
Linear spread lens etched on interior side
Steel mounting ring with torsion spring

MOUNTING:

For use in heat rock ceilings
Max. ceiling thickness - 1"

LABELING:

cUL listed
Damp location
No through branch wiring for IC at 50w
Complies with Air Leakage requirements as stated in the Model Energy Code and Washington State Energy Code

OPTICS:

Spun aluminum lamp holder with spring steel lamp retaining clips, snaps in/out for easy re-lamping
Silk screened fixture positions provide exact setting for downlight, adjustable or wall wash reflector trims
Solite lens

LAMPING:

MR16 halogen, 50w max., 12v.



PROJECT:

TYPE:

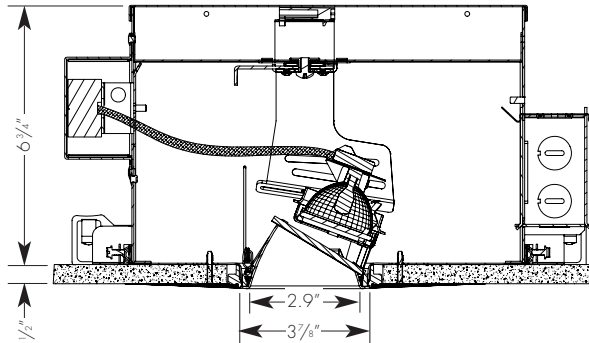
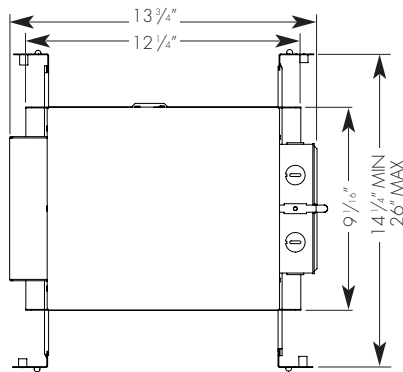

Ceiling cut out dimension: 4 1/16" dia.

ELECTRICAL

Transformer	Lamping 50w	
	Input watts	Amps
Electronic 120v	50	.42

MR16 Bi-Pin base, 50w max.

Electronic transformer compatible w/dimming systems that control electronic transformers

Amerlux reserves the right to change details that do not affect overall function and performance.

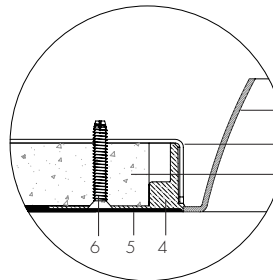

1. Reflector Trim
2. Fixture Housing Aperture Plate
3. Ceiling 5/8" (1" Max.)
4. Cast Aluminum Plaster Frame
5. Plaster Skim Coat (By Others)
6. 6-32 Type F Thread Cutting Screw

ecotECTURAL
Architectural lighting for sustainable design.



ORDERING INFORMATION:

HOUSING			REFLECTOR	
Model #	Lamp Type	Voltage	Model #	Aperture Finish
E2.9RICATTL	MR16 (50w max)	120	E2.9RLWTL	Reflector with Clear Flange (3/16" flange finish matches cone finish) SDC - semi-diffused clear CLC - specular clear GDC - specular gold BKC - specular black

Complete Unit Specification: E2.9RICATTL-MR16-120/E2.9RLWTL-SDW

Housing Only: E2.9RICATTL-MR16-120

Reflector Only: E2.9RLWTL-SDW

Cat #:

EVOKE 2.9" INSULATED CEILING ROUND LENS WALL WASH TRIMLESS

E2.9RICATTL/
E2.9RLWTL
MR16



TYPE :

ecOTECTORAL
Architectural lighting for sustainable design.



FIXTURE DATA:

Complete photometric data (.ies format) available upon request.

Evoke 2.9" Round Lens Wall Wash
Lamp: GE Q50MR16/HIR/CG40 Lamp Lumens: 1125
Recessed

ZONAL LUMEN SUMMARY

Zone	Lumens	%Lamp	%Fixt
0-30	201	17.8	54.2
0-40	296	26.3	79.9
0-60	364	32.3	98.2
0-90	370	32.9	100.0
90-180	0	0.0	0.0
0-180	370	32.9	100.0

Total Luminaire Efficiency = 32.9%

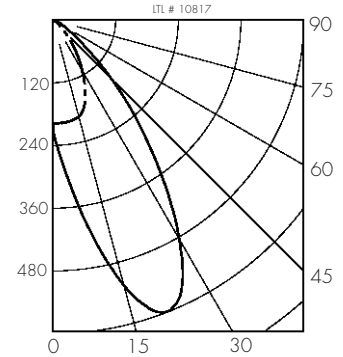

APPLICATION DATA:

Footcandles on Wall

Footcandles are average and rounded off.
Data for multiple units are based on a minimum of five units.

1.5 Feet From Wall

Distance From Ceiling	1.5'			
	1'	9.9	9.9	11.8
1'	11.8	9.9	9.9	11.8
2'	43.3	42.6	42.6	43.5
3'	41.3	41.1	41.3	42.2
4'	26.4	26.8	27.1	27.7
5'	15.9	16.3	16.7	17.0
6'	9.8	10.1	10.4	10.6
7'	6.3	6.6	6.7	6.9
8'	4.3	4.4	4.5	4.6

1.5 Feet From Wall

Distance From Ceiling	2'				
	1'	8.0	6.1	7.9	10.9
1'	10.9	8.0	6.1	7.9	10.9
2'	35.3	32.8	29.5	32.7	35.3
3'	31.6	31.5	30.5	31.5	31.6
4'	20.9	20.8	20.5	20.8	20.9
5'	13.2	13.1	13.0	13.1	13.2
6'	8.6	8.6	8.5	8.6	8.6
7'	5.9	5.8	5.8	5.8	5.9
8'	4.1	4.1	4.1	4.1	4.1

2 Feet From Wall

Distance From Ceiling	2'				
	1'	3.0	2.7	3.0	3.7
1'	3.7	3.0	2.7	3.0	3.7
2'	17.5	16.1	14.9	16.1	17.5
3'	26.1	25.8	25.7	25.8	26.1
4'	23.7	23.3	23.3	23.3	23.7
5'	17.5	17.3	17.3	17.3	17.5
6'	12.3	12.2	12.2	12.2	12.3
7'	8.6	8.6	8.6	8.6	8.6
8'	6.2	6.1	6.2	6.1	6.2