

# EVOKE 2.9" INSULATED CEILING

## SQUARE LENS WALL WASH TRIMLESS

E2.9SICATTL/  
E2.9SLWTL  
MR16

### APPLICATION:

Residential wall wash lighting

### HOUSING CONSTRUCTION:

0.050 aluminum and 20 ga. steel housing  
Powder coat matte black  
Formed aperture plate with 1/2" lip  
Cast aluminum plaster ring with perforated flange  
Adjustable mounting bars for (wood) joist construction  
Thermally protected  
GX5.3 Bi-Pin base

### OPTICS:

Formed steel lamp bracket  
Spun aluminum lamp holder with spring steel lamp retaining clips, snaps in/out for easy re-lamping  
Silk screened fixture positions provide exact setting for downlight, adjustable or wall wash reflector trims  
Solite lens

### REFLECTOR CONSTRUCTION:

Die-cast aluminum seamless self-flanged trim  
Painted finishes include matte white and optical matte black  
Linear spread lens with etched finish on interior side

### MOUNTING:

For use in sheet rock ceilings  
Max. ceiling thickness - 1"

### LABELING:

cUL listed  
Damp location  
No through branch wiring for IC at 50w  
Complies with Air Leakage requirements as stated in the Model Energy Code and Washington State Energy Code

### LAMPING:

MR16 halogen, 50w max., 12v.



PROJECT:

TYPE:

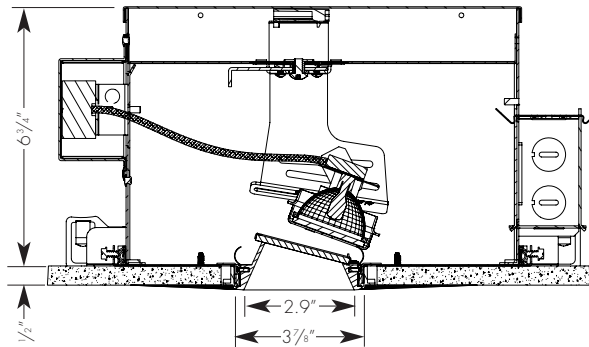
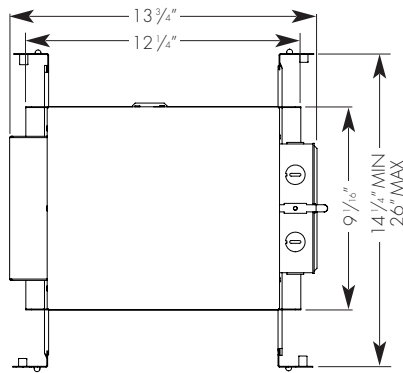

Ceiling cut out dimension: 4 1/16" sq.

### ELECTRICAL

Transformer	Lamping 50w	
	Input watts	Amps
Electronic 120v	50	.42

MR16 Bi-Pin base, 50w max.

**Electronic transformer compatible w/dimming systems that control electronic transformers**

Amerlux reserves the right to change details that do not affect overall function and performance.

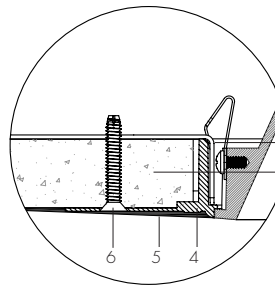

1. Reflector Trim
2. Fixture Housing Aperture Plate
3. Ceiling 5/8" (1" Max.)
4. Cast Aluminum Plaster Frame
5. Plaster Skim Coat (By Others)
6. 6-32 Type F Thread Cutting Screw

**ECOTEKTURAL**  
Architectural lighting for sustainable design.



### ORDERING INFORMATION:

HOUSING			REFLECTOR	
Model #	Lamp Type	Voltage	Model #	Aperture Finish
E2.9SICATTL	MR16 (50w max)	120	E2.9SLWTL	Reflector MB - matte black MW - matte white

Complete Unit Specification: E2.9SICATTL-MR16-120/E2.9SLWTL-MW

Housing Only: E2.9SICATTL-MR16-120

Reflector Only: E2.9SLWTL-MW

Cat #:

# EVOKE 2.9" INSULATED CEILING SQUARE LENS WALL WASH TRIMLESS

E 2.9 SICATTL/  
E 2.9 SLWTL  
MR16



TYPE :

**ecotECTURAL**  
Architectural lighting for sustainable design.



## FIXTURE DATA:

Complete photometric data (.ies format) available upon request.

Evoke 2.9" Square Lens Wall Wash  
Lamp: GE Q50MR16/HIR/CG40 Lamp Lumens: 1125  
Recessed

## ZONAL LUMEN SUMMARY

Zone	Lumens	%Lamp	%Fixt
0-30	190	16.9	49.3
0-40	287	25.5	74.3
0-60	371	33.0	96.0
0-90	386	34.3	100.0
90-180	0	0.0	0.0
0-180	386	34.3	100.0

**Total Luminaire Efficiency = 34.3%**

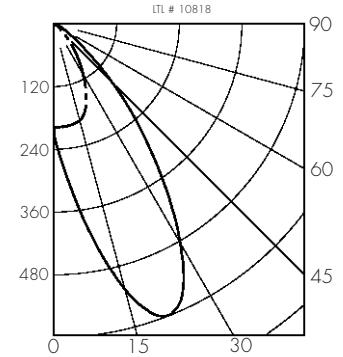

## APPLICATION DATA:

### Footcandles on Wall

Footcandles are average and rounded off.  
Data for multiple units are based on a minimum of five units.

1.5 Feet From Wall

Distance From Ceiling	1.5'			
	1'	2'	3'	4'
1'	12.9	12.8	12.8	12.9
2'	46.4	45.6	45.7	46.7
3'	41.5	41.2	41.5	42.5
4'	26.0	26.2	26.6	27.3
5'	15.3	15.7	16.0	16.4
6'	9.3	9.7	9.9	10.1
7'	6.0	6.2	6.3	6.5
8'	4.0	4.2	4.3	4.3

1.5 Feet From Wall

Distance From Ceiling	2'				
	1'	2'	3'	4'	5'
1'	11.8	10.3	8.3	10.3	11.8
2'	36.3	35.2	32.9	35.2	36.3
3'	31.8	31.7	30.7	31.7	31.8
4'	20.6	20.5	20.2	20.5	20.6
5'	12.9	12.7	12.6	12.7	12.9
6'	8.3	8.2	8.1	8.2	8.3
7'	5.5	5.5	5.5	5.5	5.5
8'	3.9	3.9	3.9	3.9	3.9

2 Feet From Wall

Distance From Ceiling	2'				
	1'	2'	3'	4'	5'
1'	4.0	3.8	3.5	3.8	4.0
2'	19.2	19.0	18.6	19.0	19.2
3'	27.5	26.9	26.8	26.9	27.5
4'	23.9	23.4	23.4	23.4	23.9
5'	17.4	17.1	17.1	17.1	17.4
6'	12.0	11.8	11.9	11.8	12.0
7'	8.3	8.2	8.3	8.2	8.3
8'	5.9	5.8	5.9	5.8	5.9