

GRUV IIS-S 6"x4', 6"x5'

1LT T5/T5HO FLUORESCENT, GRID CEILING

GRUV-IIS-S
6"x4', 6"x5'
1LT T5/T5HO

APPLICATION:

Retail and commercial recessed high efficiency ambient lighting

CONSTRUCTION:

Extruded aluminum reflector
Die-cast end caps
Die-formed, cold-rolled steel internal components and external housing

OPTICS:

1 T5/T5HO fluorescent lamp
Extruded aluminum reflector with high reflectance matte white finish
Amerlux exclusive hybrid diffuse extruded linear prism lens provides excellent transmission while effectively concealing lamp image

MOUNTING:

For use in grid ceiling applications as individual or continuous row conditions
Compliant with Armstrong Techzone™ and USG Logix™ ceiling systems
Please consult factory for any other ceiling condition

LABELING:

cUL listed



PROJECT:

TYPE:

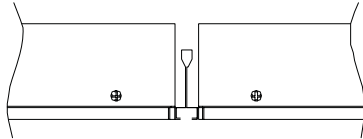
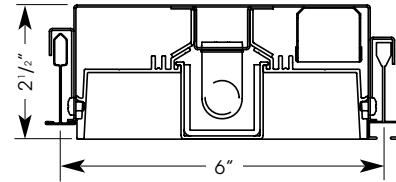
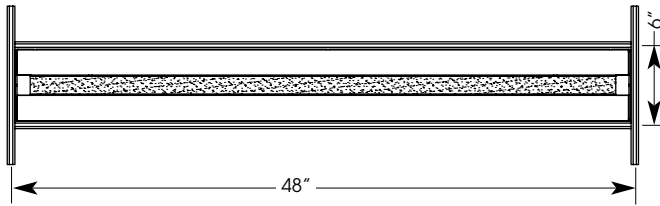

Continuous condition

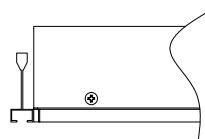

End condition

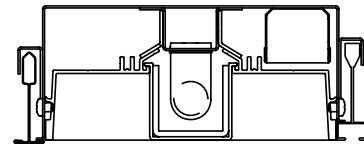

T-Grid flush mounting option

ELECTRICAL

Electronic ballast
120v-277v

Amerlux reserves the right to change details that do not affect overall function and performance.

NOTE:

See diagrams on back side for other middle and end panel options

ORDERING INFORMATION:

Model	Size	Wattage	Lamp Type	Ballast	Finish	Voltage	Ceiling Type	Options/Accessories			
GRUV-II-S-S-GRID	64 - 6"x4'	28	T5	E - electronic	HW - high reflectance matte white	120-277	916S - slot grid	DB - dimming ballast EM - emergency battery pack DL - downlight 6" panel PH - photocell 6" panel OC - occupancy sensor 6" panel SP - speaker 6" panel SPR - sprinkler 6" panel A6 - 6" air handling panel PW - 6' power whip MSW - 6' master/slave whip THW - 6' through wiring whip			
		54	T5HO				916T - T-grid				
	65 - 6"x5'	35	T5	916TF - T-grid flush mount							
		80	T5HO	1516 - T-grid							
64P - 6"x4' with end panels	65P - 6"x5' with end panels	21	T5	E - electronic	HW - high reflectance matte white	120-277	916S - slot grid 916T - T-grid 916TF - T-grid flush mount 1516 - T-grid	DB - dimming ballast EM - emergency battery pack DL - downlight 6" panel PH - photocell 6" panel OC - occupancy sensor 6" panel SP - speaker 6" panel SPR - sprinkler 6" panel A6 - 6" air handling panel PW - 6' power whip MSW - 6' master/slave whip THW - 6' through wiring whip			
		39	T5HO								
64P - 6"x4' with end panels	65P - 6"x5' with end panels	28	T5	E - electronic	HW - high reflectance matte white				120-277	916S - slot grid 916T - T-grid 916TF - T-grid flush mount 1516 - T-grid	DB - dimming ballast EM - emergency battery pack DL - downlight 6" panel PH - photocell 6" panel OC - occupancy sensor 6" panel SP - speaker 6" panel SPR - sprinkler 6" panel A6 - 6" air handling panel PW - 6' power whip MSW - 6' master/slave whip THW - 6' through wiring whip
		54	T5HO								

Example: GRUV-IIS-S-GRID-28-T5-E-HW-120-277-916S

Cat #: