

CONTOUR 3X3 MULTIPLE RECESSED 3LT LED

CNTR33R-3
LED

APPLICATION:

Retail & commercial accent & display lighting

CONSTRUCTION:

Extruded aluminum heat sink
Stamped aluminum end plates
Formed steel upper housing
Powder coat paint, available in over 200 finishes

ELECTRICAL:

Electronic constant current LED driver
120v or 277v input
Dimming down to less than 20%, available on 120v only with ELV (reverse phase) dimming equipment, consult factory for approved device list

This product complies with IEEE C62.41 for surge endurance up to 1KV. Amerlux recommends using additional surge protection with this unit (supplied by others), surge damage is not covered by warranty.

OPTICS:

LED cluster
Color Temp: 3000 (3045K ±175)
CRI: 85
Life: 50,000 hrs
Lumen Maintenance: >70% of initial lumens @ 50,000 hrs
Lumen output (@ 3000K): 1040 typ Narrow Flood (per head) 987 typ Flood 950 typ Wide Flood
0-45° tilt, 360° rotation
Beam options: Narrow Flood 16°, Medium Flood 24°, Flood 30°, Wide Flood 45°, Very Wide Flood 60°

MOUNTING:

For use in T-Grid & sheet rock ceiling

LABELING:



PROJECT:

TYPE:

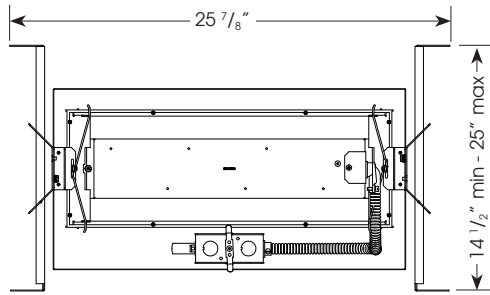

Ceiling cut out dimension: 7 1/8" x 19 3/8"

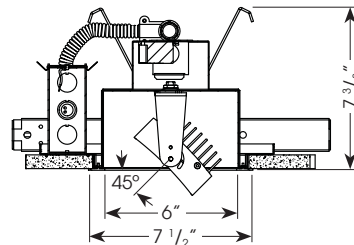
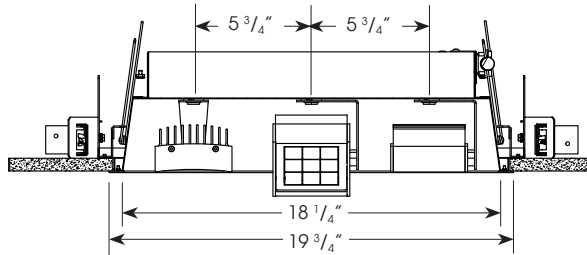

ELECTRICAL

Driver	3x24w	
	Operating Watts*	Amps*
Electronic 120v	72	.60
277v	72	.27

Class 2 constant current driver, 700 mA
*LED forward voltage bins result in actual consumed watts ranging ±10%. For circuiting planning use max watts and amp data.

ORDERING INFORMATION:

Model	# Heads	Wattage	Lamp Type	Driver	Housing/ Head Finish	Voltage	Beam Spread Head 1	Head 2	Head 3	Trim Ring Finish	Color Temp	Options
CNTR33R	3	24	LED	E - electronic	WT - white texture BT - black texture ST - silver texture ____ (other RAL)	120 277	NF MFL FL WF VWF SL	NF MFL FL WF VWF SL	NF MFL FL WF VWF SL	WT - white texture	3000	DIM - dimming (120v only) Snoot (accepts up to 2 forms of light control media) SN - snoot 1", specify WT, BT, ST finish Light Control Media (requires snoot) CB - cross blade 1/2" deep, 9 cell, black (B) finish standard HEX - hexcell louver, 1/8"x1/8" SPR - prismatic spread lens (use only with NF, FL) LSPR - linear spread lens (do not use if SL beam spread is specified)

Example: CNTR33R-1-24-LED-E-WT-120-NF-NF-NF-WT-3000

Cat #:

Amerlux reserves the right to change details that do not affect overall function and performance.



CONTOUR 3X3 MULTIPLE RECESSED 3LT LED

CNTR33R-3
LED



TYPE:



FIXTURE DATA:

Note: Data per head

Complete photometric data (ies format) available upon request.

25W LED

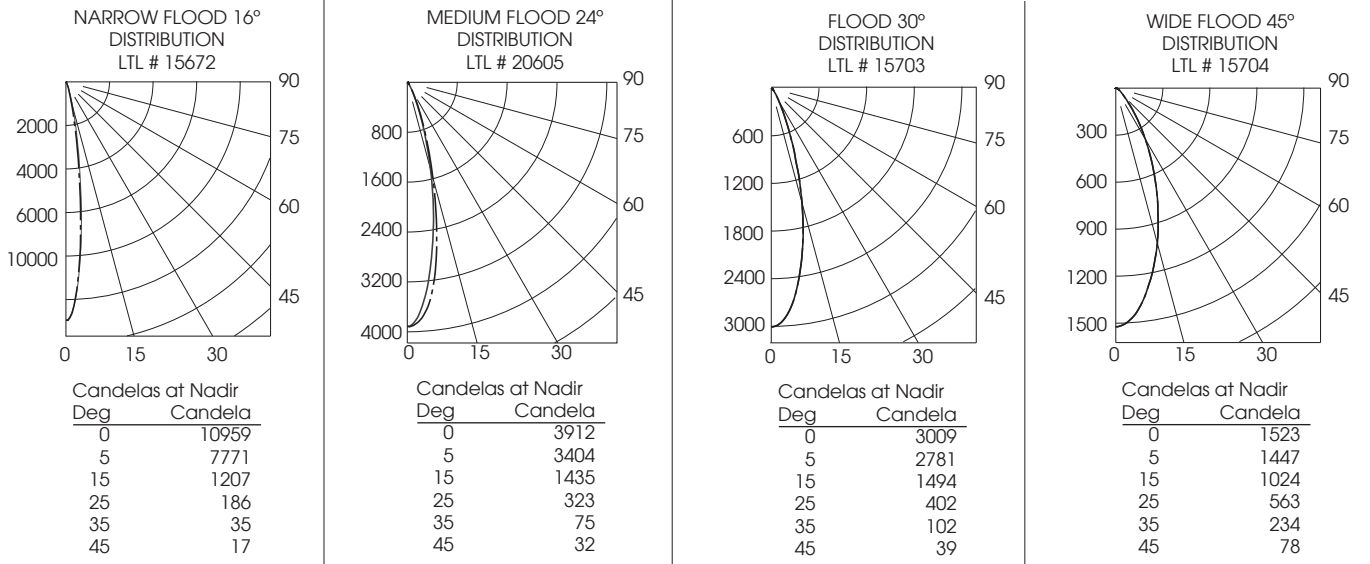

APPLICATION DATA:

Notes and Definitions:

Beam spread is to 50% center beam candlepower (CBCP).
 D=Distance to floor or wall.
 FC=Footcandles on floor or wall at center beam aiming location.
 L=Effective Visual Beam length in feet (50% of maximum footcandle level).
 W=Effective Visual Beam width in feet (50% of maximum footcandle level).
 CB=Distance across or down to center beam location.

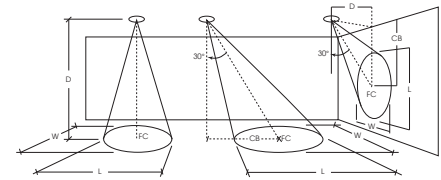

	0° Aiming Angle Horizontal Footcandles				30° Aiming Angle Horizontal Footcandles					30° Aiming Angle Vertical Footcandles					60° Aiming Angle Vertical Footcandles				
	D	FC	L	W	D	FC	L	W	CB	D	FC	L	W	CB	D	FC	L	W	CB
NARROW FLOOD	5.0'	438	1.3	1.2	5.0'	272	1.8	1.3	3.0	3.0'	171	2.7	1.4	4.7	3.0'	782	1.0	0.8	1.7
	7.5'	195	1.9	1.8	7.5'	127	2.6	2.0	4.0	4.0'	97	3.5	1.8	6.3	4.0'	450	1.4	1.1	2.2
	10.0'	110	2.6	2.5	10.0'	68	3.5	2.9	6.0	5.0'	62	4.4	2.3	7.8	5.0'	288	1.7	1.4	2.7
	12.5'	70	3.2	3.1	12.5'	46	4.2	3.5	7.0	6.0'	43	5.2	2.7	9.3	6.0'	200	2.0	1.7	3.2
MEDIUM FLOOD	5.0'	157	2.1	2.3	5.0'	98	2.8	2.7	3.0	3.0'	72	3.5	2.4	3.4	3.0'	280	1.6	1.6	1.8
	7.5'	70	3.1	3.4	7.5'	47	3.9	3.8	4.0	4.0'	41	4.6	3.1	5.3	4.0'	162	2.1	2.0	2.3
	10.0'	39	4.1	4.5	10.0'	26	5.3	5.1	5.0	5.0'	26	5.7	3.9	6.7	5.0'	104	2.6	2.6	2.7
	12.5'	25	5.2	5.6	12.5'	17	6.6	6.4	7.0	6.0'	18	6.9	4.7	7.7	6.0'	73	3.1	3.0	3.3
FLOOD	5.0'	120	2.6	2.6	5.0'	78	3.2	2.9	2.0	3.0'	64	3.5	2.4	3.7	3.0'	221	1.9	1.7	1.2
	7.5'	54	3.7	3.7	7.5'	36	4.6	4.2	4.0	4.0'	36	4.6	3.2	4.8	4.0'	127	2.5	2.3	1.7
	10.0'	30	5.0	5.0	10.0'	21	6.1	5.6	5.0	5.0'	23	5.7	4.0	5.7	5.0'	82	3.0	2.8	2.3
	12.5'	19	6.2	6.2	12.5'	13	7.6	6.9	6.0	6.0'	16	6.9	4.8	7.3	6.0'	57	3.6	3.4	2.7
WIDE FLOOD	5.0'	61	3.3	3.3	5.0'	43	3.9	3.6	2.0	3.0'	40	3.9	3.0	2.7	3.0'	119	2.4	2.2	1.2
	7.5'	27	4.9	4.9	7.5'	19	5.9	5.4	3.0	4.0'	23	5.2	3.9	3.7	4.0'	67	3.1	2.9	1.8
	10.0'	15	6.5	6.5	10.0'	11	7.8	7.2	4.0	5.0'	15	6.5	4.9	4.7	5.0'	43	3.9	3.6	2.3
	12.5'	10	8.1	8.1	12.5'	7	9.7	9.0	6.0	6.0'	10	7.7	5.9	5.7	6.0'	30	4.7	4.3	2.7