

# Acion

## Large LED Accent



ACOL.x.x.BLK

### Features

The Amerlux Acion accent luminaire employs solid state technology and precision engineering to provide small scale LED solutions in landscape and architectural layouts. All components are encapsulated inside a single attractive enclosure designed for superior performance in weather resistant applications. Offered in a choice of beam spreads, finishes, and color temperatures, two mounting options and glare shield are also available.

### Product Overview

Type:	Exterior Accent
Wattage:	17W
Lumen Output :	1,360 lm
Color Temp:	2700K, 3000K, 3500K, 4000K
Dimming:	ELV trailing edge dimming only

PROJECT:

TYPE:

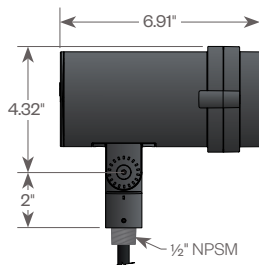
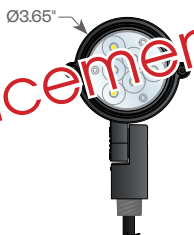

### Application:

Exterior accent lighting for landscapes, including small signs and features.

### Construction:

- Die-cast aluminum
- IP67 sealed optical chamber and integral driver chamber
- Easy "two-screw" integral driver access, does not disturb optical chamber seal
- Flush lens prevents puddles/water deposits in upward facing applications
- 180° Knuckle mount
- Vertical aiming lock, with tamper-resistant tooled locking after final aiming

### Optics:

- Lumen maintenance: 70% @ 50,000 hours
- 10°, 15°, 30°, 40°, 60°, 60x10, 60x30, 90x60 beam spreads are available with secondary shaping lens

### Electrical:

- Integral driver
- Input voltage 120V-277V auto-sensing
- 1/2" NPSM wire entry
- Drive current 700mA
- Power consumption 17W
- ELV trailing edge dimming only

**ETL listed, suitable for wet locations.**

### Mounting Accessories:

- (order separately)
- Ground Stake (GSP17)

### Optical Accessories:

- Hexcell Louver (HCL)
- Half Glare Shield (HGL)

### Finish:

Premium quality thermoset polyester powdercoat for a durable finish.



**5** year limited warranty  
AMERLUX LED



## PROJECT:

## TYPE:

### Luminaire Ordering Information

ACCL

1

2

3

4

5

1

Model  
ACCL

2

Color Temp  
27 - 2700K  
30 - 3000K  
35 - 3500K  
40 - 4000K

3

Beam Spread  
10 - 10°  
15 - 15°  
30 - 30°  
40 - 40°  
60 - 60°  
H6010 - 60° x 10°  
H6030 - 60° x 30°  
H9060 - 90° x 60°  
V6010 - 60° x 10°  
V6030 - 60° x 30°  
V9060 - 90° x 60°

4

Finish  
BLK - Satin Black  
CLB - Classic Bronze  
GRN - Green  
WHT - White  
CSTM - Custom

5

Optical Accessories  
HCL - Hexcell Louver  
HGL - Half Glare Shield

### Mounting Accessories Ordering Information (order separately)

1

2

1

Mounting Accessories  
GSP17 - Ground Stake (black polycarbonate)  
JBOX - Junction Box (finish matches fixture finish)  
JCOV - Junction Mount (finish matches fixture finish)

2

Finish  
BLK - Satin Black  
CLB - Classic Bronze  
GRN - Green  
WHT - White  
CSTM - Custom

## PROJECT:

## TYPE:

### Optical Accessories

**HGL**  
(Half Glare Shield)

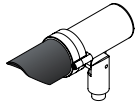

**HCL**  
(Hexcell Louver)

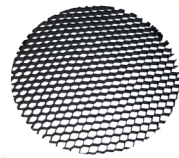

### Mounting Accessories (order separately)

**GSP17**  
(Ground Stake)

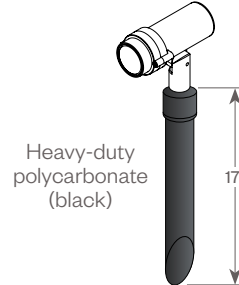

**JCOV**  
(Junction Mount)

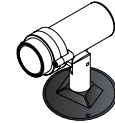

**JBOX**  
(Junction Box)



Finish will match luminaire color

### Optical Performance - Polar Graphs

ACCL-27-10

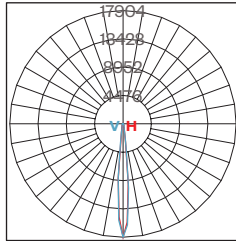

Maximum Candela = 17,904  
Located at Horizontal Angle = 0  
Vertical Angle = 0  
H - Horizontal Axial Candela  
V - Vertical Axial Candela

ACCL-27-30

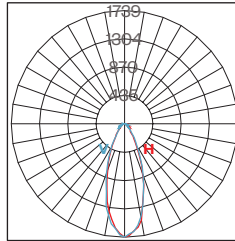

Maximum Candela = 1,739  
Located at Horizontal Angle = 0  
Vertical Angle = 0  
H - Horizontal Axial Candela  
V - Vertical Axial Candela

ACCL-27-40

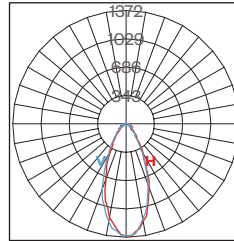

Maximum Candela = 1,372  
Located at Horizontal Angle = 2.5  
Vertical Angle = 2.5  
H - Horizontal Axial Candela  
V - Vertical Axial Candela

ACCL-27-60

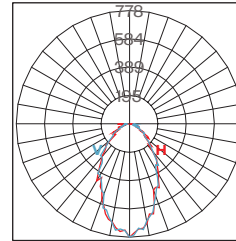

Maximum Candela = 778  
Located at Horizontal Angle = 0  
Vertical Angle = 0  
H - Horizontal Axial Candela  
V - Vertical Axial Candela

ACCL-27-60X10

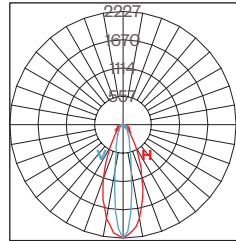

Maximum Candela = 2,227  
Located at Horizontal Angle = 0  
Vertical Angle = 0  
H - Horizontal Axial Candela  
V - Vertical Axial Candela

ACCL-27-60X30

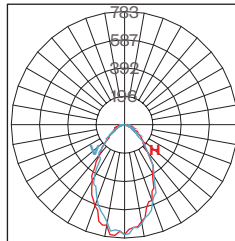

Maximum Candela = 783  
Located at Horizontal Angle = 5  
Vertical Angle = 2.5  
H - Horizontal Axial Candela  
V - Vertical Axial Candela

ACCL-27-90X60

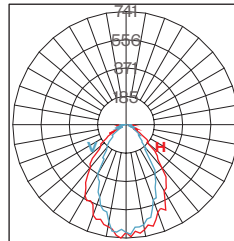

Maximum Candela = 741  
Located at Horizontal Angle = 2.5  
Vertical Angle = 0  
H - Horizontal Axial Candela  
V - Vertical Axial Candela

NOTE: Data represents the use of light shaping filters.  
Complete photometric data (ies format) available upon request.

### Performance Chart

Pattern	Beam Spread	Approx. Lumens	Total Efficacy
Symmetrical	10 (10°)	1240-1360	72-80 lm/W
	15 (15°)	1190-1305	70-76 lm/W
	30 (30°)	1140-1250	67-73 lm/W
	40 (40°)	1130-1250	66-73 lm/W
	60 (60°)	1110-1190	65-70 lm/W
Horizontal	H6010 (60°x10°)	980-1180	57-69 lm/W
	H6030 (60°x30°)	1070-1190	62-70 lm/W
	H9060 (90°x60°)	1050-1170	61-68 lm/W
Vertical	V6010 (60°x10°)	1180-980	69-57 lm/W
	V6030 (60°x30°)	1190-1070	70-62 lm/W
	V9060 (90°x60°)	1170-1050	68-61 lm/W