

# Curvano® 2.5"

## Curved Linear Direct



PROJECT:

TYPE:

### Features

Curvano expands on the existing linear slot portfolio of Amerlux, further putting the “arch” in first-class architectural lighting. The 2.5” profile is available in 5 diameter options, as either a curved corner or full 360° circle. With the ability to fit in seamlessly anywhere on your project, from the simplest design to the most complex, Curvano provides infinite design and lighting patterns options: circular, serpentine and rounded-circle displays included. Trust Curvano to provide the freedom to create—and maintain—dynamic, head-turning spaces.

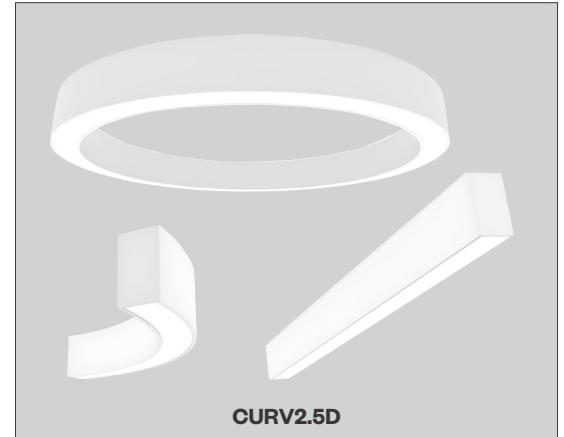

### Product Overview

|                  |   |
|------------------|---|
| Type:            | Pendant/Surface Mount Direct  |
| Wattage:         | 3W-10W/ft   |
| Color Temp:      | 2700K, 3000K, 3500K, 4000K  |
| CRI:             | 83 or 90+ typ.  |
| Dimming (wired): | 0-10V, 1% dim (standard)<br>Lutron LDE1 Hi-lume® 1% Soft-On/Fade-to-Black<br>DALI, 1% dim |

### Certifications



### Fixture Summary

#### Performance Data

| Wattage per Foot | Delivered Lumens | Lumens per Foot | Lumens per Watt |
|------------------|------------------|-----------------|-----------------|
| 5                | 1672             | 418             | 84.6            |
| 10               | 3059             | 765             | 77.6            |

Data is based on 4' fixture with Designer Lens, 3500K-80 120V IES files available on website.

#### Electrical Data

| Wattage per Foot | Voltage | System Watts | Amps |
|------------------|---------|--------------|------|
| 5                | 120V    | 20           | 0.16 |
|                  | 277V    | 20.8         | 0.08 |
| 10               | 120V    | 39.7         | 0.33 |
|                  | 277V    | 39.7         | 0.15 |

Electronic multi-volt (120-277VAC), constant current LED driver, 4' fixture.

# Curvano® 2.5"

Curved Linear Direct



PROJECT:

TYPE:

## Ordering Information

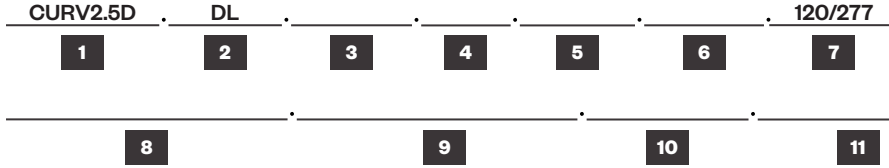

| 1 | Model    | 2 | Optics           | 3 | Mounting  |
|---|----------|---|------------------|---|---|
|   | CURV2.5D |   | DL designer lens |   | <p><b>Pendant Mount</b> (<i>aircraft cable suspension</i>)</p> <p><b>ASW04*</b> through ceiling tile or gyp board, white, 4'</p> <p><b>ASW10</b> through ceiling tile or gyp board, white, 10'</p> <p><b>ASW20</b> through ceiling tile or gyp board, white, 20'</p> <p><b>ASB04*</b> through ceiling tile or gyp board, black, 4'</p> <p><b>ASB10</b> through ceiling tile or gyp board, black, 10'</p> <p><b>ASB20</b> through ceiling tile or gyp board, black, 20'</p> <p><b>ASW04T*</b> over ceiling tee, white, 4'</p> <p><b>ASW10T</b> over ceiling tee, white, 10'</p> <p><b>ASW20T</b> over ceiling tee, white, 20'</p> <p><b>ASB04T*</b> over ceiling tee, black, 4'</p> <p><b>ASB10T</b> over ceiling tee, black, 10'</p> <p><b>ASB20T</b> over ceiling tee, black, 20'</p> <p><i>* 4' (xxx04) is standard length, other lengths are additional charge</i></p> |
|   |          |   |                  |   | <p><b>Mini Cable Suspension</b> (<i>required for D22/D36/D43 ARC &amp; CIR configurations only</i>)</p> <p><b>MASW10</b> through ceiling tile or gyp board, white, 10'</p> <p><b>MASB10</b> through ceiling tile or gyp board, black, 10'</p> <p><b>MASW10T</b> over ceiling tee, white, 10'</p> <p><b>MASB10T</b> over ceiling tee, black, 10'</p>   |
|   |          |   |                  |   | <p><b>Surface Mount</b></p> <p><b>SM</b> surface mount</p>  |

| 4              | Wattage (per foot) | 5        | Color Temp-CRI                               | 6 | Finish                                      | 7 | Voltage | 8 | Length   |          |          |          |                |                |      |       |  |      |       |  |  |       |  |  |
|----------------|--------------------|----------|--|---|---|---|---------|---|--|----------|----------|----------|----------------|----------------|------|-------|--|------|-------|--|--|-------|--|--|
| 3              |                    |          | 80+ CRI                                      |   | HW high reflectance matte white             |   | 120/277 |   | <table border="1"> <thead> <tr> <th>Length A</th> <th>Length B</th> <th>Length C</th> </tr> </thead> <tbody> <tr> <td>- all patterns</td> <td>- all patterns</td> <td>- PU</td> </tr> <tr> <td>- IND</td> <td></td> <td>- PZ</td> </tr> <tr> <td>- CON</td> <td></td> <td></td> </tr> <tr> <td>- CUS</td> <td></td> <td></td> </tr> </tbody> </table> <p><i>For CIR and ARC configurations, skip to "Diameter &amp; Angle"</i></p> | Length A | Length B | Length C | - all patterns | - all patterns | - PU | - IND |  | - PZ | - CON |  |  | - CUS |  |  |
| Length A       | Length B           | Length C |  |   |   |   |         |   |  |          |          |          |                |                |      |       |  |      |       |  |  |       |  |  |
| - all patterns | - all patterns     | - PU     |  |   |   |   |         |   |  |          |          |          |                |                |      |       |  |      |       |  |  |       |  |  |
| - IND          |                    | - PZ     |  |   |   |   |         |   |  |          |          |          |                |                |      |       |  |      |       |  |  |       |  |  |
| - CON          |                    |          |  |   |   |   |         |   |  |          |          |          |                |                |      |       |  |      |       |  |  |       |  |  |
| - CUS          |                    |          |  |   |   |   |         |   |  |          |          |          |                |                |      |       |  |      |       |  |  |       |  |  |
| 4              |                    |          | 30 3000K-80+ 279 2700K-90+                   |   | BT black texture                            |   |         |   |  |          |          |          |                |                |      |       |  |      |       |  |  |       |  |  |
| 5              |                    |          | 35 3500K-80+ 309 3000K-90+                   |   | ST silver texture                           |   |         |   |  |          |          |          |                |                |      |       |  |      |       |  |  |       |  |  |
| 6              |                    |          | 40 4000K-80+ 359 3500K-90+                   |   | <i>For other RAL color, consult factory</i> |   |         |   |  |          |          |          |                |                |      |       |  |      |       |  |  |       |  |  |
| 7              |                    |          | 409 4000K-90+                                |   |   |   |         |   |  |          |          |          |                |                |      |       |  |      |       |  |  |       |  |  |
| 8              |                    |          | <i>Consult factory for 90+ CRI lead time</i> |   |   |   |         |   |  |          |          |          |                |                |      |       |  |      |       |  |  |       |  |  |
| 9              |                    |          |  |   |   |   |         |   |  |          |          |          |                |                |      |       |  |      |       |  |  |       |  |  |
| 10             |                    |          |  |   |   |   |         |   |  |          |          |          |                |                |      |       |  |      |       |  |  |       |  |  |

| 9          | Diameter & Angle   | 10         | Configuration  |         |       |  |       |       |  |           |           |  |      |      |  |      |      |  |  |      |  |  |   |
|------------|--|------------|--|---------|-------|--|-------|-------|--|-----------|-----------|--|------|------|--|------|------|--|--|------|--|--|---|
|            | <p><b>D22</b> 22" diameter</p> <p><b>D36</b> 36" diameter</p> <p><b>D43</b> 43" diameter</p> <p><b>D72</b> 72" diameter</p> <p><b>D100</b> 100" diameter</p> <p><b>CD___</b> custom diameter</p>   |            | <p><b>A45</b> 45° angle</p> <p><b>A90</b> 90° angle</p> <p><b>A135</b> 135° angle</p> <p><b>A180</b> 180° angle</p> <p><b>CA___</b> custom angle</p> |         |       |  |       |       |  |           |           |  |      |      |  |      |      |  |  |      |  |  |   |
|            | <table border="1"> <thead> <tr> <th>(diameter)</th> <th>X</th> <th>(angle)</th> </tr> </thead> <tbody> <tr> <td>- ARC</td> <td></td> <td>- ARC</td> </tr> <tr> <td>- CIR</td> <td></td> <td>- PLL/PLR</td> </tr> <tr> <td>- PLL/PLR</td> <td></td> <td>- PU</td> </tr> <tr> <td>- PU</td> <td></td> <td>- PZ</td> </tr> <tr> <td>- PR</td> <td></td> <td></td> </tr> <tr> <td>- PZ</td> <td></td> <td></td> </tr> </tbody> </table> <p><i>See page 3 for more details and restrictions.</i></p> <p><i>Patterns with multiple corners to have the same diameter &amp; angle throughout. For IND/CON/CUS skip to "Configuration."</i></p> <p><i>For jobs with architectural drawings, original CAD file (.DWG) is required to quote.</i></p> | (diameter) | X  | (angle) | - ARC |  | - ARC | - CIR |  | - PLL/PLR | - PLL/PLR |  | - PU | - PU |  | - PZ | - PR |  |  | - PZ |  |  | <p><b>IND</b> - individual straight fixtures, 2' to 8' (<i>in 1" increments</i>)</p> <p><b>CON</b> - continuous run, &gt; than 8', specify to nearest foot</p> <p><b>CUS</b> - custom made to measure, +/- 1/8" of customer supplied field dimensions</p> <p><b>ARC</b> - individual curved fixtures, see diameter and angle options above</p> <p><b>CIR</b> - circle (<i>D22, D36, D43 ships assembled; D72, D100 ships in 90° sections</i>)</p> <p><b>Standard Patterns</b> (<i>see page 3 for details</i>)</p> <p><b>PLL</b> - L left, (2) straight + (1) corner, leg right</p> <p><b>PLR</b> - L left, (2) straight + (1) corner, leg left</p> <p><b>PU</b> - U shape, (3) straight lengths + (2) corners</p> <p><b>PR</b> - Rectangle, (4) straight lengths + (4) corners</p> <p><b>PZ</b> - Z shape, (3) straight lengths + (2) corners</p> <p><i>For custom patterns, submit EDR on amerlux.com</i></p> <p><b>Minimum 10 pieces required for any custom diameter or angle.</b></p> |
| (diameter) | X  | (angle)    |  |         |       |  |       |       |  |           |           |  |      |      |  |      |      |  |  |      |  |  |   |
| - ARC      |  | - ARC      |  |         |       |  |       |       |  |           |           |  |      |      |  |      |      |  |  |      |  |  |   |
| - CIR      |  | - PLL/PLR  |  |         |       |  |       |       |  |           |           |  |      |      |  |      |      |  |  |      |  |  |   |
| - PLL/PLR  |  | - PU       |  |         |       |  |       |       |  |           |           |  |      |      |  |      |      |  |  |      |  |  |   |
| - PU       |  | - PZ       |  |         |       |  |       |       |  |           |           |  |      |      |  |      |      |  |  |      |  |  |   |
| - PR       |  |            |  |         |       |  |       |       |  |           |           |  |      |      |  |      |      |  |  |      |  |  |   |
| - PZ       |  |            |  |         |       |  |       |       |  |           |           |  |      |      |  |      |      |  |  |      |  |  |   |

| 11 | Drivers/Controls  | 12 | Options/Accessories   |
|----|---|----|---|
|    | <p><b>O-10V</b> 1% electronic dimming, multi-volt, 120-277VAC constant current driver (<i>standard</i>)</p> <p><b>DALI</b> DALI dimming 120-277VAC, 1% dim</p> <p><b>HILUME-H-EOO</b> Lutron LDE1 Hi-lume® 1% dim Soft-On/Fade-to-Black</p> |    | <p><b>EMC-PF</b> emergency circuit requires power feed located in last fixture section (<i>for other locations consult factory</i>)</p> <p><b>PF</b> extra power feed for additional circuiting</p> <p><b>EMB</b> emergency battery pack (<i>4' + straight fixtures only</i>)</p> |

PROJECT:

TYPE:

### Diameter and Angle Options

Arc length is the center line length if the curve was straightened out.

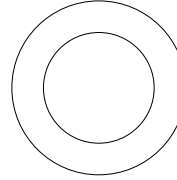
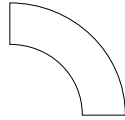

| 45°      |            |
|----------|------------|
| Diameter | Arc Length |
| D43      | 16.89"     |
| D72      | 28.08"     |
| D100     | 39.27"     |

| 90°      |            |
|----------|------------|
| Diameter | Arc Length |
| D22      | 16.98"     |
| D36      | 28.18"     |
| D43      | 33.77"     |
| D72      | 56.16"     |
| D100     | 78.54"     |

| 360°     |            |
|----------|------------|
| Diameter | Arc Length |
| D22      | 67.54"     |
| D36      | 112.72"    |
| D43      | 135.09"    |
| D72*     | 224.62"    |
| D100*    | 314.16"    |

### Standard Patterns

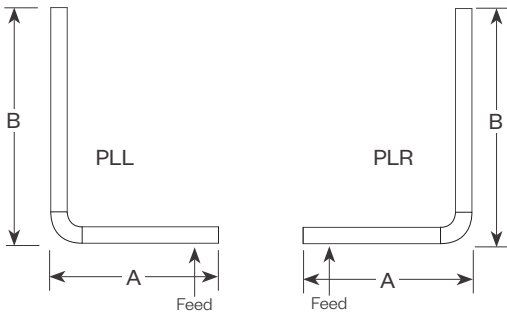

**PLL** - L Left, (2) straights + (1) corner, leg right  
**PLR** - L Right, (2) straights + (1) corner, leg left  
 Provide overall lengths: A' & B'; Diameter & Angle of corner  
**Example: 4'x8'.D43xA90.PLL**

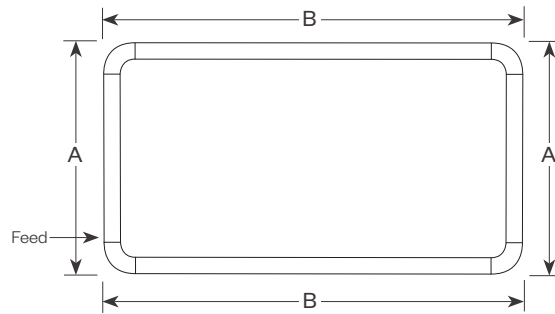

**PR** - Closed Rectangle, (4) straight lengths + (4) 90° corners  
 Provide overall lengths: A' & B'; Diameter  
**Example: 12'x10'.D22.PR**

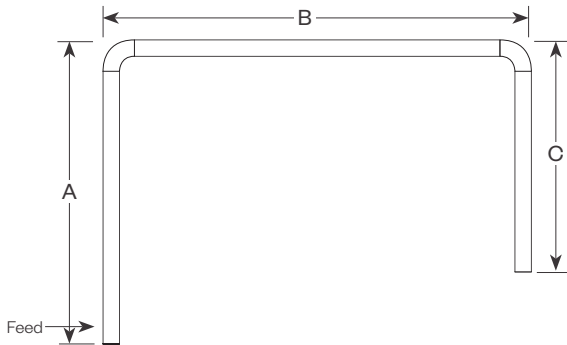

**PU** - Open U, (3) straights + (2) corners  
 Provide overall lengths: A' B' & C'; Diameter & Angle of corners  
**Example: 4'x10'.D72xA90.PU**

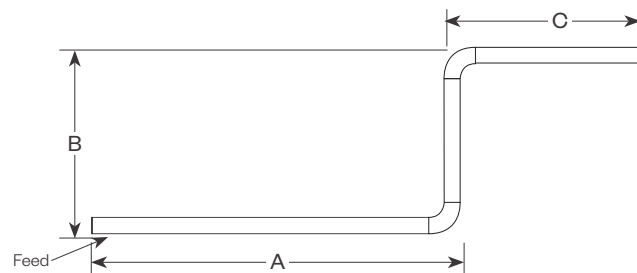

**PZ** - Open Z, (3) straights + (2) corners  
 Provide overall lengths: A' B' & C'; Diameter & Angle of corners  
**Example: 12'x6'x10'.D36XA90.PZ**

# Curvano® 2.5"

## Curved Linear Direct



PROJECT:

TYPE:

### Specifications

#### Application

Retail and commercial ambient lighting that can be customized with a variety of diameters and angles to create any curved pattern or variety of illuminated circles.

#### Construction

Extruded aluminum housing. Die-cast End Plates match fixture body finish. Die-formed, cold-rolled steel internal components are protected against rust and corrosion.

#### Optical

Laser cut acrylic lens, with lift and shift lay-in design. Maximum length is 8' and maximum angle is 90° (ex. 180° curve will have 2 lenses; Circle will have 4 lenses). All lenses ship installed into fixture. Amerlux's proprietary acrylic lens provide excellent transmission while effectively concealing source image.

**DL** - Designer Lens provides flat even glow on lens

**UC** - Upper Clear Lens cover

**BAT** - Batwing upright (only available in straight runs)

#### LED

Amerlux fixtures have excellent thermal management and offer a 5 year warranty. Our LED binning is within 3 MacAdam ellipse. Boards are configured for maximum flexibility resulting in even illumination no matter the fixture layout. LED boards are easily replaced in the field with just a Phillips screw driver.

**Color Temperature Options:** 2700K, 3000K, 3500K, 4000K

**CRI:** 83 or 90+ typical

**R9:** 16 @ CRI 83; >50 @ CRI 90+

**Life:** 50,000+ hr., > 70% of initial lumens (L70)

#### Electrical

**Wiring:** Individual and "Beginning of Run" (BOR) fixtures are prewired with power cord. All configurations have quick connect power harnesses for row connections.

1 - 1 Circuit, direct & indirect same circuit

2 - 2 Circuits, direct & indirect switch separately (power feed at both ends)

**Remote Driver Wiring (D22, D36 & D43 ARC or CIR only):** Driver is supplied installed in remote driver box, (one driver per box), with 5' of low voltage plenum rated cable. Fixture supplied with 18/2 SJT power cord ready to be connected to J-Box (by others) over cable canopy. Amerlux recommends a maximum of 15' between the fixture and the remote driver box. Consult factory with job specific electrical spec if more than 15' is required. Feeds are added as required by specified wattage and driver maximums. See page 5 for wiring illustration

**Standard Wattage:** 3-10 W/ft (3W & 4W have a minimum length of 4'). Emergency circuit via remote invert or auxiliary emergency power supply (by others)

**This product complies with IEEE C62.41 for surge endurance up to 2.5KV. Amerlux® recommends using additional surge protection with this unit (supplied by others), surge and over voltage damage is not covered under warranty.**

**EMC-PF** - Emergency circuit requires power feed to be located in last fixture section for continuous runs. For other locations consult factory. Not available for individual (IND) configuration.

**PF** - Extra power feed for additional circuiting. Not available for individual (IND) configuration.

**EMB** - Emergency battery pack - 10W output power, 90 min of illumination time. Illuminated test-switch/charging indicator light is provided. Wattage consumption by EMB: 2.5W/ft (4ft fixture), 1.66W/ft (6ft fixture), 1.25W/ft (8ft fixture). Request can be made to light up 4ft section on 8ft unit.

#### Finish

All painted surfaces are premium powder coated baked on for maximum durability and color stability.

**HW** - High reflective matte White

**BT** - Black Texture

**ST** - Silver Texture

For special paint colors supply RAL and/or actual paint chip for factory consultation.

#### Configurations/Lengths

**IND** - Individual straights are standalone fixtures made of single lengths of 2' to 8' (in 1' increments). They are supplied with matching painted End Caps and the required mounting hardware. Lengths less than 4' may have restrictions based upon wattage, lengths, drivers or other options.

**CON** - Continuous runs are longer than 8', specified to the nearest whole foot. Continuous runs less than 16' are made of 2 lengths. Continuous runs longer than 16' start with a 8' Beginning of Row (BoR) wired with a power feed and fitted with an End Cap. The majority of the runs are made up of 8' Middle of Run (MoR) lengths. End of Run (EoR) units are made up of 2' to 8' units to the nearest whole foot or a combination of a last 4' MoR and a 5', 6' or 7' EoR. Runs longer than 60' may require a second power feed. Factory installed pins and splines simplify fixture alignment. Lengths are quickly joined with "catch and latch" mechanisms or screws and sturdy brackets. Quick connectors simplify field wiring.

**CUS** - Custom made to measure runs are made to nearest 1/8" of customer supplied field measurements. They can be a single custom length or runs configured as described above only EoR's are 2' to 8' cut to the nearest 1/8" exact length or a combination of a last 4' MoR with an EoR cut to exact length to the nearest 1/8".

**ARC** - Individual arcs are standalone fixtures made of single lengths using a diameter and an angle (ex. D43 x A90 is a 4' diameter, 90° individual fixture). They are supplied with matching painted End Caps and the required mounting hardware. All diameters utilize a remote mounted driver.

**CIR** - Circle fixtures made up of a single housing (D22, D36 & D43) or shipped in 90° segments (D72, D100). All diameters utilize a remote mounted driver.

**PLL/PLR/PR/PU/PZ** - Standard patterns consist of standard diameter & angle corners with standard lengths (3' to 8' in 1' increments) or custom lengths. Patterns with multiple corners will have the same diameter and angle utilized throughout the pattern. Depending upon complexity of the pattern, drawings may be required. When ordering please give overall lengths. See page 3 for layouts.

**PC** - Custom patterns use standard or custom lengths, 90° or other corner angles with some limitations. Please provide drawings and consult factory.

#### Mounting

**CURV2.5D....ASW10** - Direct/Indirect installed in center of ceiling tile or gypsum board ceiling, (standard) i.e. ASW10. Or if canopy is installed on a grid Tee runner add, T i.e. ASW10T.

**Cable Suspension:** Cable is stranded stainless steel wire supplied with cable gripper and 5"x .250" steel die formed canopy. All components are protected against rust and corrosion. Power feeds are 16 gauge 3 or 5 conductor SJT cord supplies in same color as canopy. Amerlux supplies the required feed and non-feed suspension kits based upon length, electrical options and customer requirements. Suspension kit options include: color, length and mounting condition.

**Mini Cable Suspension:** 5" diameter by 0.25" canopy is used for both feed and non-feed Mini Cable Kits. The thinner Low Voltage power feeds are 22 gauge 2 conductor SJT cords supplied in same color as canopy. Amerlux supplies the required feed and non-feed suspension kits based upon length, electrical options and customer requirements. Suspension kit options include: color and mounting condition.

**Surface Mounting:** Housing needs to be attached to solid structure above. Mounting holes are pre-drilled at factory. Some fixture disassembly and reassembly required. Mounting hardware by others.

#### Certifications

Approved to UL standards as tested by CSA. Intended for indoor use only

#### Warranty

Amerlux's 5 year limited warranty. Please consult Amerlux website for details.

# Curvano® 2.5"

Curved Linear Direct



PROJECT:

TYPE:

## Product Details

### Cross Section

#### Pendant Mount

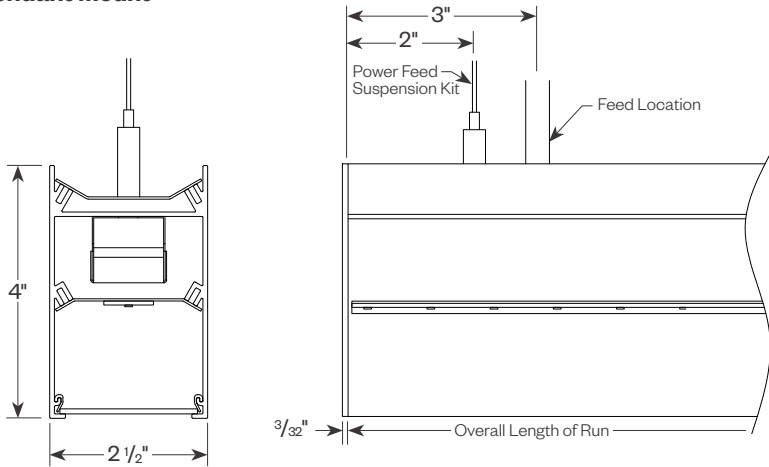

#### Surface Mount

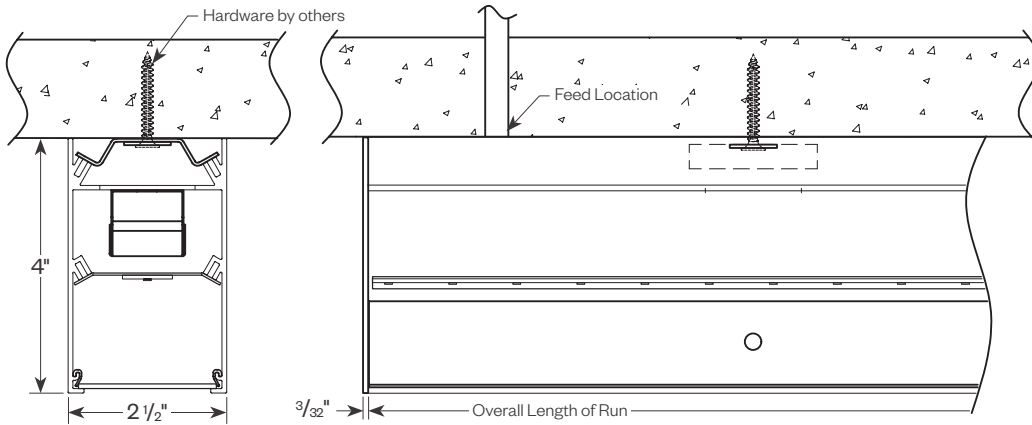

## Lens Install/Removal

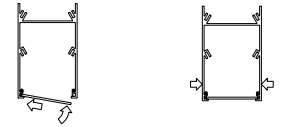

Insert Lens into one side at an angle and push into flexible lens clip. Tilt lens up past bottom flange and into fixture.

If lens shows a gap on one side squeeze fixture to center lens between lens clips.

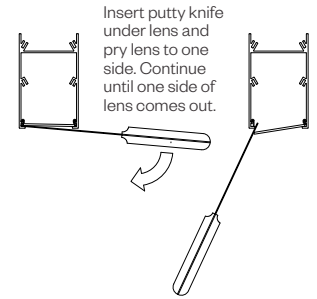

Insert putty knife under lens and pry lens to one side. Continue until one side of lens comes out.

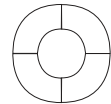

Circle Lens

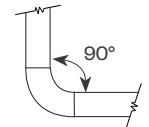

Rounded Corner Lens

## Tool-less Joining

Line up the two housings by using the alignment pins & splines. Secure them together by using the Catch & Latch System on the top of or inside the extrusion.

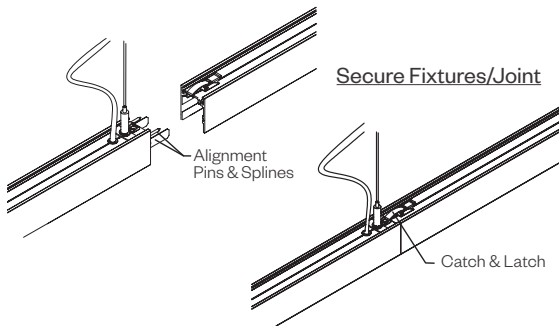

## Remote Driver

D22/36/43 ARC & CIR configurations only  
Note: Driver required for every 4'. Remote drivers can be installed up to 15' max from fixture.

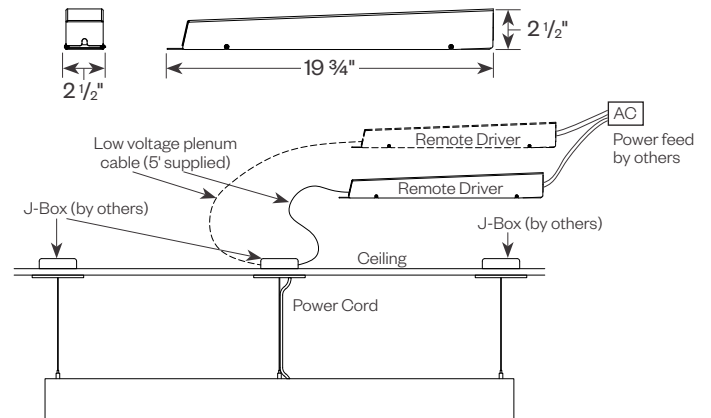

# Curvano® 2.5"

Curved Linear Direct



|                 |              |
|-----------------|--------------|
| <b>PROJECT:</b> | <b>TYPE:</b> |
|-----------------|--------------|

**Run Lengths and Dimensions** (View from top of fixture, Black dots represent mounting points)

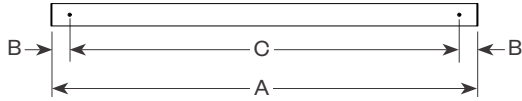

| IND    |           |         |          |
|--------|-----------|---------|----------|
| Length | A         | B       | C        |
| 2'     | 24"       | 2-3/32" | 19-7/8"  |
| 3'     | 35-7/8"   | 2-3/32" | 31-3/4"  |
| 4'     | 47-3/4"   | 2-3/32" | 43-9/16" |
| 5'     | 59-11/16" | 2-3/32" | 55-1/2"  |
| 6'     | 71-9/16"  | 2-3/32" | 67-3/8"  |
| 7'     | 83-7/16"  | 2-3/32" | 79-1/4"  |
| 8'     | 95-5/16"  | 2-3/32" | 91-1/8"  |

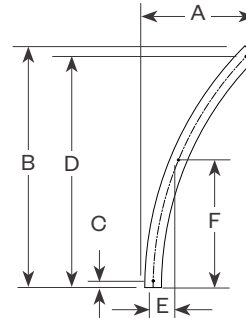

| 45° ARC  |         |          |    |          |          |           |
|----------|---------|----------|----|----------|----------|-----------|
| Diameter | A       | B        | C  | D        | E        | F         |
| D43      | 8-7/16" | 16-1/16" | 1" | 14-1/2"  | 1-5/8"   | 8-1/4"    |
| D72      | 12-5/8" | 26-3/16" | 1" | 24-9/16" | 2-3/4"   | 13-11/16" |
| D100     | 16-3/4" | 36-1/4"  | 1" | 34-5/8"  | 3-13/16" | 19-1/8"   |

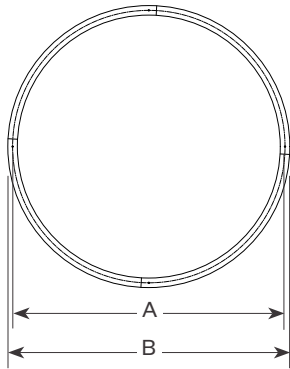

| CIR      |         |          |
|----------|---------|----------|
| Diameter | A       | B        |
| D22      | 21-5/8" | 24-1/8"  |
| D36      | 35-7/8" | 38-3/8"  |
| D43      | 43"     | 45-1/2"  |
| D72      | 71-1/2" | 74"      |
| D100     | 100"    | 102-1/2" |

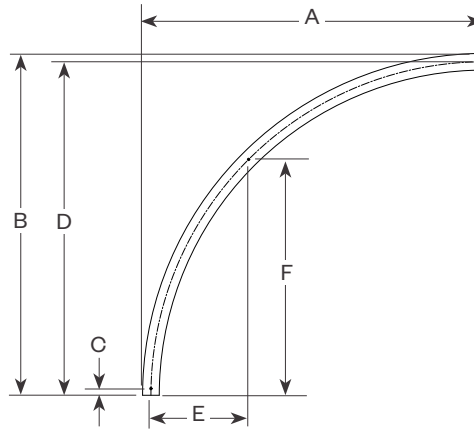

| 90° ARC  |          |          |    |           |         |           |
|----------|----------|----------|----|-----------|---------|-----------|
| Diameter | A        | B        | C  | D         | E       | F         |
| D22      | 12-1/16" | 12-1/16" | 1" | 10-3/4"   | 3-3/16" | 7-5/8"    |
| D36      | 19-3/16" | 19-3/16" | 1" | 17-15/16" | 5-1/4"  | 12-11/16" |
| D43      | 22-3/4"  | 22-3/4"  | 1" | 21-1/2"   | 6-5/16" | 15-3/16"  |
| D72      | 37"      | 37"      | 1" | 35-3/4"   | 10-1/2" | 25-1/4"   |
| D100     | 51-1/4"  | 51-1/4"  | 1" | 50"       | 14-5/8" | 35-3/8"   |

# Curvano® 2.5"

Curved Linear Direct



PROJECT:

TYPE:

## Cable Kit Suspension - Ceiling or Gypsum Board (ASW04, ASW10, ASW20, ASB04, ASB10, ASB20, MASW10, MASB10)

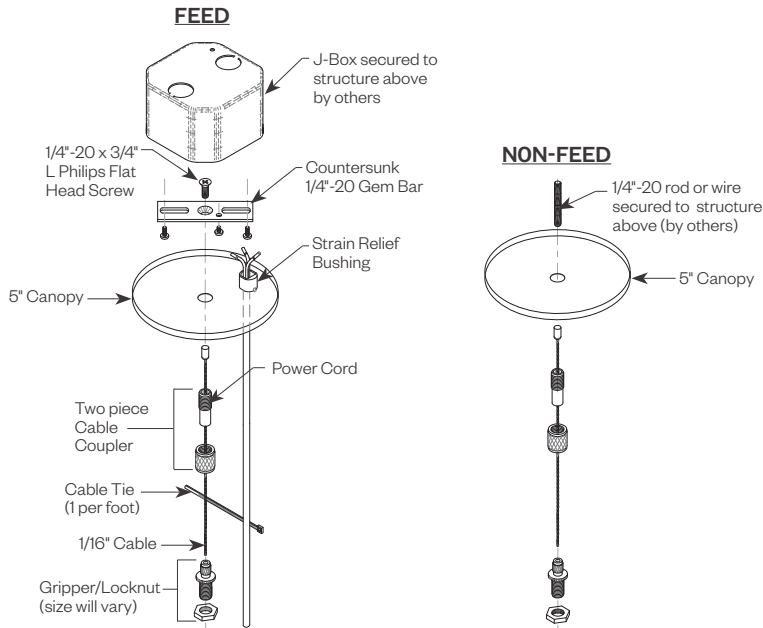

| Cat#    | Length | Cord/Canopy | Application         |
|---------|--------|-------------|---------------------|
| ASW04   | 4'     | white/white | ceiling tile/gypsum |
| ASW10   | 10'    | white/white | ceiling tile/gypsum |
| ASW20   | 20'    | white/white | ceiling tile/gypsum |
| ASB04   | 4'     | black/black | ceiling tile/gypsum |
| ASB10   | 10'    | black/black | ceiling tile/gypsum |
| ASB20   | 20'    | black/black | ceiling tile/gypsum |
| ASW04T  | 4'     | white/white | ceiling tee         |
| ASW10T  | 10'    | white/white | ceiling tee         |
| ASW20T  | 20'    | white/white | ceiling tee         |
| ASB04T  | 4'     | black/black | ceiling tee         |
| ASB10T  | 10'    | black/black | ceiling tee         |
| ASB20T  | 20'    | black/black | ceiling tee         |
| MASW10  | 10'    | white/white | ceiling tile/gypsum |
| MASB10  | 10'    | black/black | ceiling tile/gypsum |
| MASW10T | 10'    | white/white | ceiling tee/gypsum  |
| MASB10T | 10'    | black/black | ceiling tee/gypsum  |

## Tee Grid or Screw Slot (ASW04T, ASW10T, ASW20T, ASB04T, ASB10T, ASB20T, MASW10T, MASB10T)

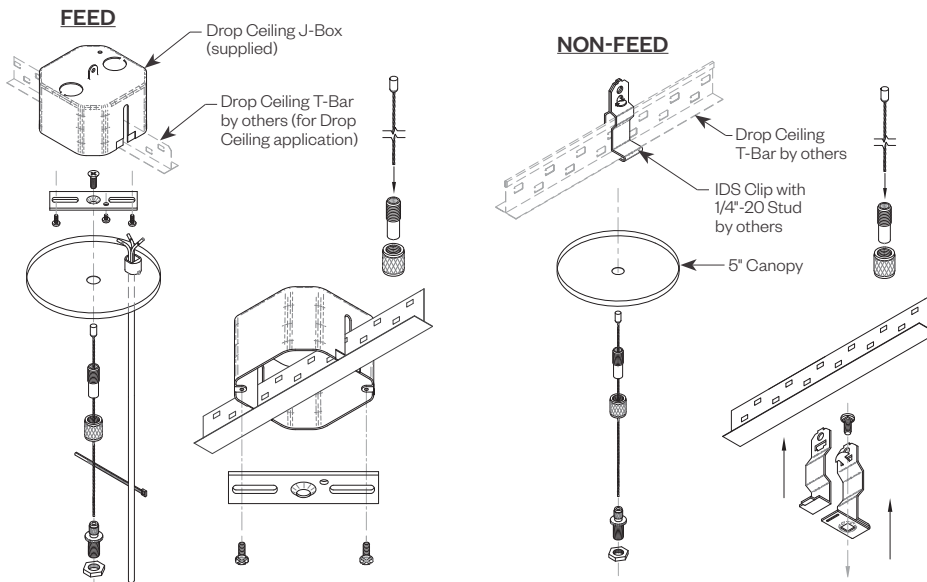

# Curvano® 2.5"

Curved Linear Direct



|                 |              |
|-----------------|--------------|
| <b>PROJECT:</b> | <b>TYPE:</b> |
|-----------------|--------------|

## Performance Data

**Multiplying Factors:** (Multiplying Factor is based on 3500K-83 120V IES file on website)

| Wattage: | 3W   | 4W   | 5W  | 6W   | 7W   | 8W  | 9W   | 10W  |
|----------|------|------|-----|------|------|-----|------|------|
| Factor:  | 0.67 | 0.83 | 1.0 | 1.17 | 1.33 | 1.5 | 1.66 | 1.83 |

| CCT:    | 3000K-83 | 3500K-83 | 4000K-83 |
|---------|----------|----------|----------|
| Factor: | 0.97     | 1.0      | 1.01     |

| Wattage: | 3W   | 4W   | 5W   | 6W   | 7W   | 8W   | 9W   | 10W |
|----------|------|------|------|------|------|------|------|-----|
| Factor:  | 0.37 | 0.46 | 0.55 | 0.73 | 0.73 | 0.82 | 0.91 | 1.0 |

| CCT:    | 2700K-90+ | 3000K-90+ | 3500K-90+ | 4000K-90+ |
|---------|-----------|-----------|-----------|-----------|
| Factor: | 0.90      | 0.93      | 0.96      | 0.97      |

### CURV2.5D DL 5W 3500K 4FT

Total Watts: 20

Total Lumens: 1672

Source: 112 direct White LEDs

LTL# 13450111.01

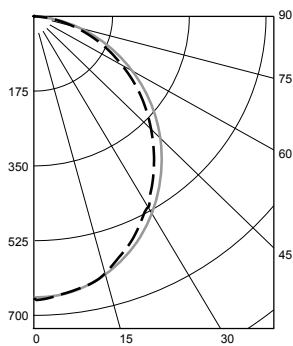

#### ZONAL LUMEN SUMMARY

| Zone   | Lumens | %Fixt |
|--------|--------|-------|
| 0-40   | 790    | 47.3  |
| 0-60   | 1345   | 80.5  |
| 0-90   | 1672   | 100.0 |
| 90-180 | 0      | 0.0   |

**Efficacy = 84.6 Lumens /Watt**

#### COEFFICIENTS OF UTILIZATION

Effective Floor Cavity Reflectance 20%

| RC  | 80  |     |     |     |
|-----|-----|-----|-----|-----|
| RW  | 70  | 50  | 30  | 10  |
| RCR |     |     |     |     |
| 0   | 119 | 119 | 119 | 119 |
| 1   | 109 | 104 | 100 | 96  |
| 2   | 99  | 91  | 85  | 79  |
| 3   | 91  | 80  | 72  | 66  |
| 4   | 83  | 71  | 63  | 56  |
| 5   | 77  | 64  | 55  | 49  |
| 6   | 71  | 58  | 49  | 43  |
| 7   | 66  | 52  | 44  | 38  |
| 8   | 61  | 48  | 40  | 34  |
| 9   | 57  | 44  | 36  | 31  |
| 10  | 54  | 41  | 33  | 28  |

Values are expressed as percent of total lumen output delivered to the task surface.

### CURV2.5D DL 10W 3500K 4FT

Total Watts: 39

Total Lumens: 3059

Source: 112 direct White LEDs

LTL# 13450111.04

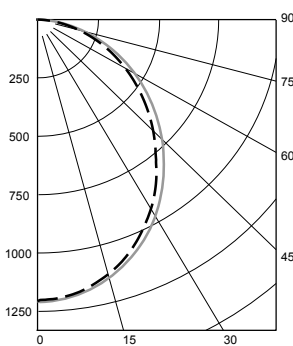

#### ZONAL LUMEN SUMMARY

| Zone   | Lumens | %Fixt |
|--------|--------|-------|
| 0-40   | 1449   | 47.4  |
| 0-60   | 2452   | 80.2  |
| 0-90   | 3059   | 100.0 |
| 90-180 | 0      | 0.0   |

**Efficacy = 77.6 Lumens /Watt**

#### COEFFICIENTS OF UTILIZATION

Effective Floor Cavity Reflectance 20%

| RC  | 80  |     |     |     |
|-----|-----|-----|-----|-----|
| RW  | 70  | 50  | 30  | 10  |
| RCR |     |     |     |     |
| 0   | 119 | 119 | 119 | 119 |
| 1   | 109 | 104 | 100 | 96  |
| 2   | 99  | 91  | 84  | 79  |
| 3   | 91  | 80  | 72  | 66  |
| 4   | 83  | 71  | 63  | 56  |
| 5   | 77  | 64  | 55  | 49  |
| 6   | 71  | 58  | 49  | 43  |
| 7   | 66  | 52  | 44  | 38  |
| 8   | 61  | 48  | 40  | 34  |
| 9   | 57  | 44  | 36  | 31  |
| 10  | 54  | 41  | 33  | 28  |

Values are expressed as percent of total lumen output delivered to the task surface.



# Curvano® 2.5"

Curved Linear Direct



PROJECT:

TYPE:

## Dimming Compatibility

Amerlux® Carisma fixtures are compatible with all major dimming protocols prevalent in the United States. Please see below for general compatibilities and wiring diagrams. Amerlux recommends testing your unique dimming configuration as the exact full configuration (*Dimmer, Fixture Quantity, Voltage, etc*) may affect dimming performance.

--- NOTE: INFORMATION BELOW IS FOR WIRED DIMMERS ONLY. FOR WIRELESS DIMMERS, CONSULT FACTORY ---

### 0-10V - DIMMING (Standard)

Integrates into a variety of building management and daylighting controls

**Notes:**

- 120V or 277V\*
- Dims down to 1% light output
- Requires interface to turn off power to driver
- Consult Dimming manufacturer for installation instructions - **DO NOT SHARE NEUTRALS!**

### 0-10V Wiring Diagram

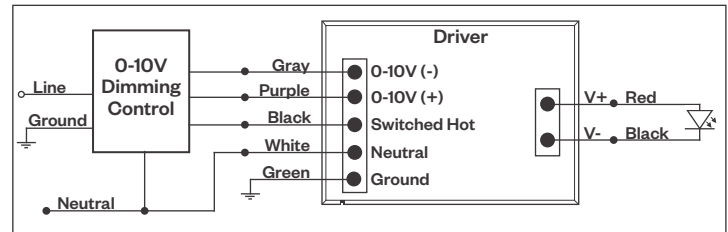

| Compatible Dimmers†: |              |           | Central System                            |
|----------------------|--------------|-----------|---|
| Wall Box             |              |           |   |
| Lutron:              | Wattstopper: | Leviton:  | Lutron Grafikx Eye with GRX-TV1 Interface |
| Diva - DVSTV         | ADF-120277   | Renoir II |   |
| Maestro - MS-Z101    |              |           |   |
| Nova-T - NTSTV-DV    |              |           |   |

### LUTRON LDE1 DIMMING

Integrates into Lutron EcoSystem building management

**Notes:**

- 120VAC or 277VAC\*
- Dims down to 1% Soft-On/Fade-to-Black
- EcoSystem Control
- Consult Dimming manufacturer for installation instructions - **DO NOT SHARE NEUTRALS!**

### LDE1 (HILUME-H-ECO) EcoSystem Digital Control Wiring Diagram

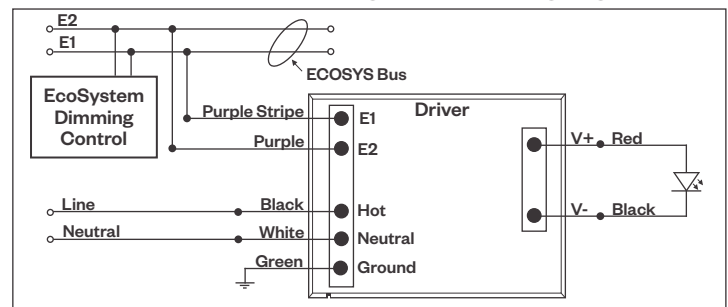

| Compatible Dimmers†:    |  | Central System                       |
|-------------------------|--|--------------------------------------|
| Lutron ECO System       |  |                                      |
| Pow Pak Dimming Modules |  | Lutron EcoSystem compatible controls |
| Energi Savr Node        |  |                                      |
| Grafik Eye QS/Homeworks |  |                                      |
| QS Control Unit         |  |                                      |
| Quantum Hub             |  |                                      |
| Homeworks QS/My Room    |  |                                      |

### DALI - DALI DIMMING 120V-277V

Digital control protocol allows individual fixture control

**Notes:**

- 120VAC - 277VAC\*
- Dims down to 1% light output in most cases

### DALI Wiring Diagram

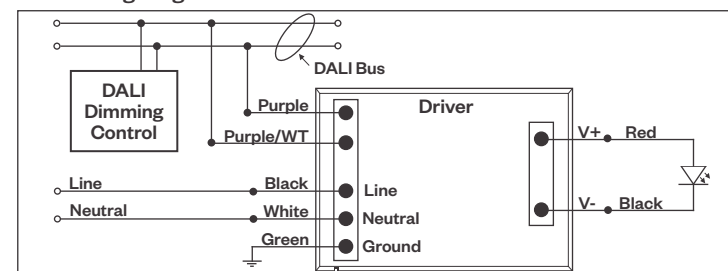

| Compatible Dimmers†:     |  | Central System |
|--------------------------|--|----------------|
| Wall Box                 |  |                |
| Leviton CD250 Controller |  | Dynalite       |
|                          |  | Fifth Light    |

**Notes:**  
 \* Driver is 277VAC dimmable with appropriate dimmer (*by others*). All provided wiring diagrams show 120VAC wiring colors and method. Please refer to 277VAC dimmer installation instructions for 277VAC wiring diagrams.  
 † The absence of a dimmer from the lists above does not imply incompatibility. Please consult factory for compatibility inquiries.