

Amerlux Current Limiting Device

1 Circuit or 2 Circuit Global Track, 120V or 277V



PROJECT:

TYPE:

Features

The Current Limiting Device from Amerlux limits the amount of electrical load placed on a run of track. The device has an integrated rocker-style circuit breaker switch with On/Off markings and an integral track connector that is keyed for polarity by order based on feed direction. Cover is molded of UL-approved polycarbonate and is color-matched for use with Global GES, TEK and HTEK track systems from Amerlux.

Product Overview

Type: Current Limiting
Circuit(s): 1 circuit or 2 circuit
Voltage: 120V or 277V



End Feed



Middle Feed
(only for ACL-GES (model))

Certifications



Specifications

Electrical Data

Amps	Watts (120V)	Watts (277V)
1	120	277
3	360	831
5	600	1385
8	960	2077
10	1200	2770

Amerlux recommends loading to not more than 80% of capacity, to eliminate nuisance tripping.

Amerlux Current Limiting Device

1 Circuit or 2 Circuit Global Track, 120V or 277V



PROJECT:

TYPE:

ACL-GES, 1 Circuit, 120V Ordering Information



1	Model	2	Finish
	ACL-GES11 current limiting device with live end (<i>left</i>) feed		1 silver gray with black circuit breaker
	ACL-GES12 current limiting device with live end (<i>right</i>) feed		2 black with black circuit breaker
	ACL-GES14 current limiting device with middle feed		3 white with white circuit breaker
	ACL-REM-120 current limiting device, remote mounted, 120V (<i>This option is not Title 24 CEC listed</i>)		
	ACL-GES11-SUS current limiting device with live end (<i>left</i>) feed, suspended with track		
	ACL-GES12-SUS current limiting device with live end (<i>right</i>) feed, suspended with track		
	ACL-GES14-SUS current limiting device with middle feed, suspended with track		
3	Amp Rating - Circuit Breaker 1	4	Amp Rating - Circuit Breaker 2
	<u>Standard Breakers</u> <u>Special Order Breakers (non-standard*)</u>		<i>(For use with ACL-GES14, ACL-REM-120 & ACL-GES14-SUS only)</i>
	1A 0.5A		<u>Standard Breakers</u> <u>Special Order Breakers (non-standard*)</u>
	3A 1.5A		1A 0.5A
	5A 2A		3A 1.5A
	8A 2.5A		5A 2A
	10A 4A		8A 2.5A
			10A 4A
			6A
			7A
			9A
			<i>* Non-standard breaker sizes require additional lead times, consult factory.</i>

Note: For ACL-TEK ordering, see pg 3.
For ACL-HTEK ordering, see pg 4.

Amerlux Current Limiting Device

1 Circuit or 2 Circuit Global Track, 120V or 277V



PROJECT:

TYPE:

ACL-TEK, 2 Circuit/2 Neutral, 120V Ordering Information

<div><div>1</div><div>2</div><div>3</div><div>4</div></div>			
1 Model		2 Finish	
ACL-TEK11 current limiting device with live end (<i>left</i>) feed		1 silver gray with black circuit breaker	
ACL-TEK12 current limiting device with live end (<i>right</i>) feed		2 black with black circuit breaker	
ACL-REM-120 current limiting device, remote mounted, 120V (<i>This option is not Title 24 CEC listed</i>)		3 white with white circuit breaker	
ACL-TEK11-SUS current limiting device with live end (<i>left</i>) feed, suspended with track			
ACL-TEK12-SUS current limiting device with live end (<i>right</i>) feed, suspended with track			
3 Amp Rating - Circuit Breaker 1		4 Amp Rating - Circuit Breaker 2	
<u>Standard Breakers</u>		<u>Standard Breakers</u>	
<u>Special Order Breakers (non-standard*)</u>		<u>Special Order Breakers (non-standard*)</u>	
1A	0.5A	1A	0.5A
3A	1.5A	3A	1.5A
5A	2A	5A	2A
8A	2.5A	8A	2.5A
10A	4A	10A	4A
	6A		6A
	7A		7A
	9A		9A
* Non-standard breaker sizes require additional lead times, consult factory.		* Non-standard breaker sizes require additional lead times, consult factory.	

Note: For ACL-GES ordering, see pg 2.
For ACL-HTEK ordering, see pg 4.



Amerlux Current Limiting Device

1 Circuit or 2 Circuit Global Track, 120V or 277V



PROJECT:

TYPE:

ACL-HTEK, 2 Circuit/2 Neutral, 277V Ordering Information

1		2		3		4					
1	Model			2	Finish						
	ACL-HTEK11 current limiting device with live end (left) feed				1 silver gray with black circuit breaker						
	ACL-HTEK12 current limiting device with live end (right) feed				2 black with black circuit breaker						
	ACL-REM-277 current limiting device, remote mounted, 277V (This option is not Title 24 CEC listed)				3 white with white circuit breaker						
	ACL-HTEK11-SUS current limiting device with live end (left) feed, suspended with track										
ACL-HTEK12-SUS current limiting device with live end (right) feed, suspended with track											
3	Amp Rating - Circuit Breaker 1			4	Amp Rating - Circuit Breaker 2						
	Standard Breakers		Special Order Breakers (non-standard*)		Standard Breakers		Special Order Breakers (non-standard*)				
	1A		0.5A		1A		0.5A				
	3A		1.5A		3A		1.5A				
	5A		2A		5A		2A				
	8A		2.5A		8A		2.5A				
	10A		4A		10A		4A				
			6A				6A				
			7A				7A				
			9A				9A				
			* Non-standard breaker sizes require additional lead times, consult factory.						* Non-standard breaker sizes require additional lead times, consult factory.		

Note: For ACL-GES ordering, see pg 2.
For ACL-TEK ordering, see pg 3.



Amerlux Current Limiting Device

1 Circuit or 2 Circuit Global Track, 120V or 277V



PROJECT:

TYPE:

Specifications

Application

Limits the amount of electrical load placed on a run of single or 2 circuit track to meet Energy Code restrictions

Construction

Cover: Molded UL approved polycarbonate, color-matched to track components

Mounting Plate: Stamped steel 16 ga. zinc plated integral track connector is keyed for polarity by order based on feed direction.

Circuit Breaker: Integrated rocker style circuit breaker features ON/OFF markings

Snap-in circuit breaker contains screw terminals for 12 ga. copper conductors.

Electrical

120V or 277V, 60hz capacity

Integrated circuit breaker in a variety of amp ratings

Finish

Black, white or gray

Mounting

Surface mounts directly to a 4" octagonal j-box.

Compatible with Global GES 1 circuit 120V, TEK 2 circuit/2 neutral 120V, or HTEK 2 circuit/2 neutral 277V track systems.

Remote and suspension mounting options (*see pg 7*).

Certifications

cUL listed

Title 24 CEO listed (*excluding the ACL-REM-xxx model*)



Delta Intelligent Building Technologies

178 Bauer Drive, Oakland, NJ 07436 • P: 973-882-5010 F: 973-882-2605 • amerlux.com
Amerlux reserves the right to change details that do not affect overall function and performance.
LIT-2138 • 08/20/25 • Page 5 of 7

Amerlux Current Limiting Device

1 Circuit or 2 Circuit Global Track, 120V or 277V



PROJECT:

TYPE:

Product Details - ACL-GES (1 circuit, 120V)

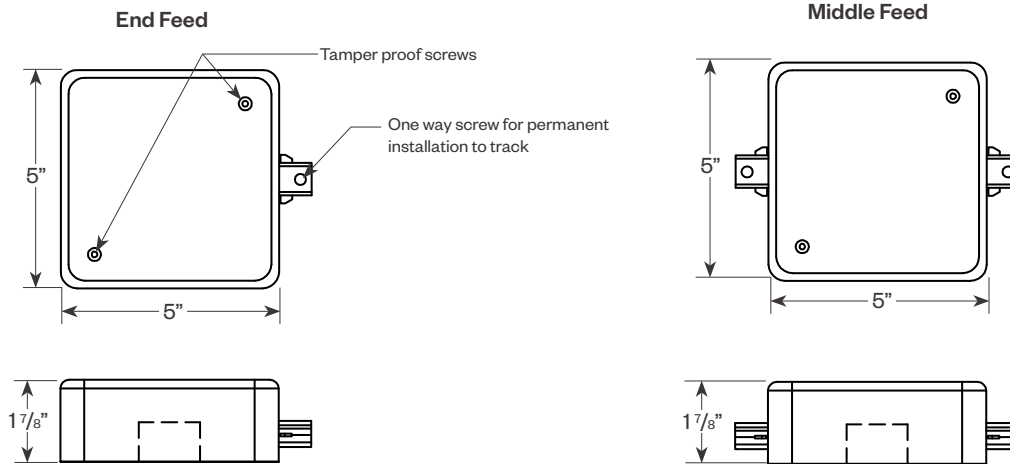

Product Details - ACL-TEK (2 circuit/2 neutral, 120V)

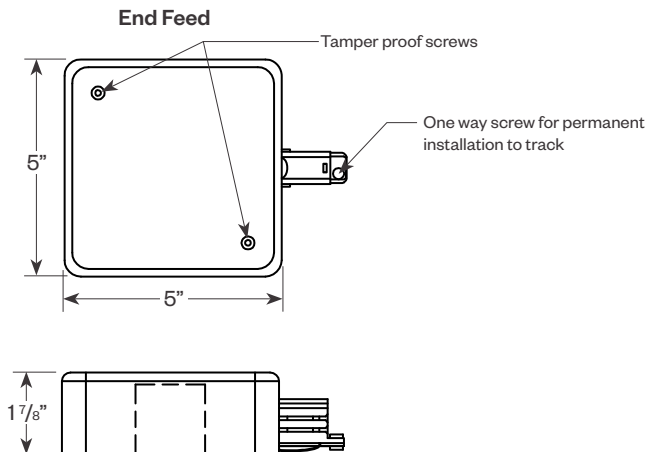

Product Details - ACL-HTEK (2 circuit/2 neutral, 277V)

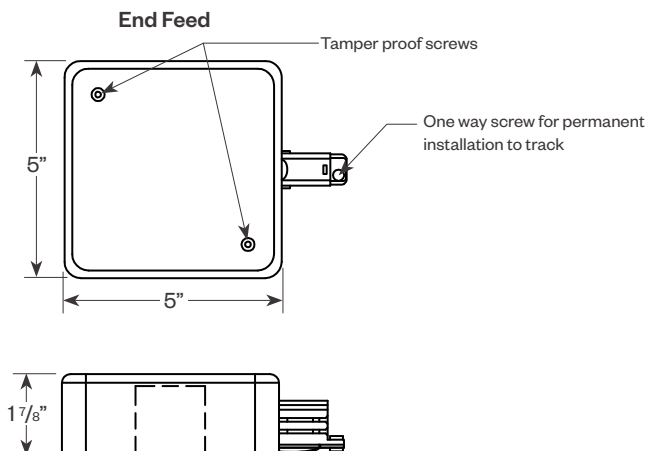

Amerlux Current Limiting Device

1 Circuit or 2 Circuit Global Track, 120V or 277V



PROJECT:

TYPE:

Mounting Options

Remote Options:

Cable:

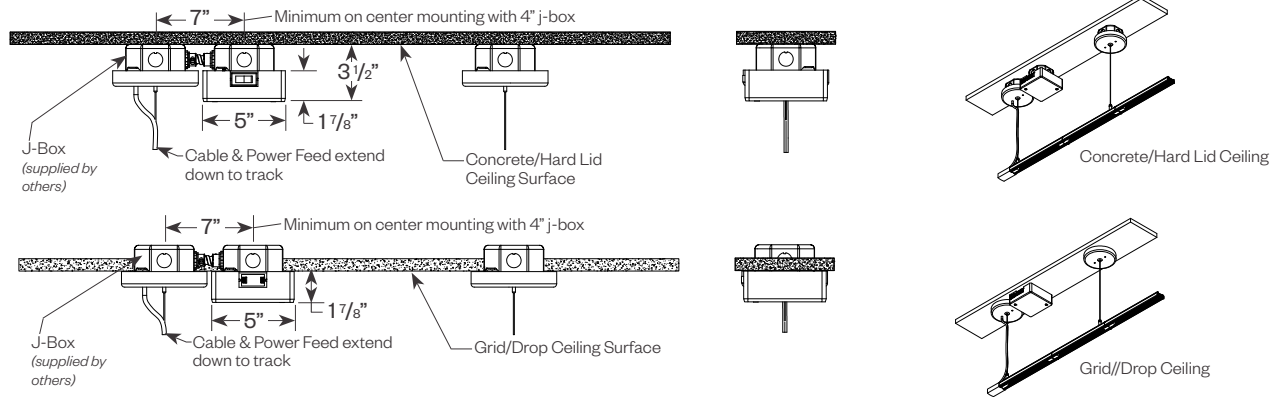

Rigid Stem:

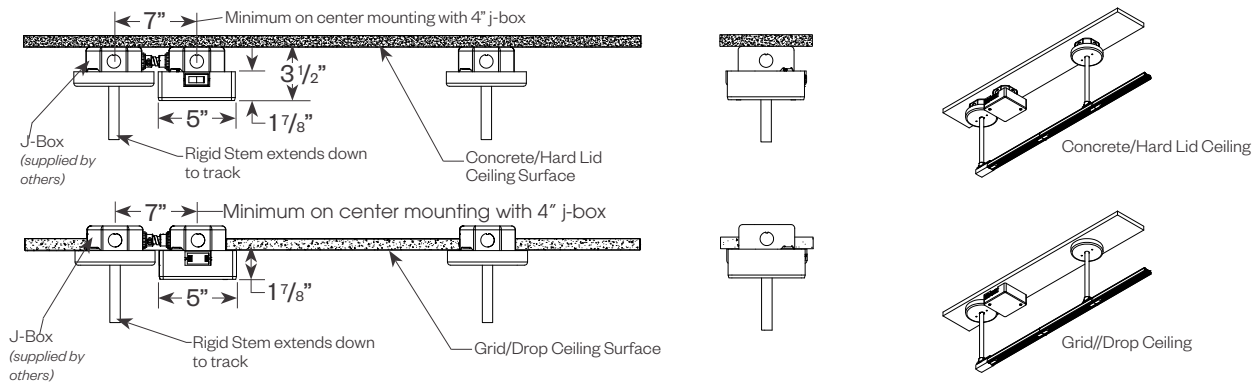

Suspension Options:

