

# TEK Global Track

2 Circuit/2 Neutral, 120V



PROJECT:

TYPE:

## Features

Global TEK track is a 120V power supply track for Amerlux track-lighting fixtures. Featuring a well-designed extruded aluminum profile which allows suspension points up to 6' o.c., the track offers two independent 20-amp circuits maximizing lighting control options including dimming (*using dimmable light sources*). This track can be installed in straight runs or configured in patterns using the available track components and accessories.



## Product Overview

Type: Track Power Supply  
Circuit(s): 2 circuit/2 neutral  
Voltage: 120V  
Amps: 20 amps per circuit

## Certifications



## Specifications

### Application

Power supply for Amerlux® track lighting fixtures.

### Construction

Architectural grade, extruded aluminum housing.  
Milled grounding bar provides continuous ground contact.  
Continuously crimped conductor ensures mechanical strength and electrical reliability.

### Electrical

2 circuit/2 neutral, 120V, 20 amps per circuit.

### Finish

Black, White or Gray.

### Mounting

T-grid, threaded rod, aircraft cable suspension or surface mount options.  
6' max on center suspension points.

# TEK Global Track

2 Circuit/2 Neutral, 120V



PROJECT:

TYPE:

## Track Ordering Information

1	2
1 Model	2 Finish
TEK44 4' (48")	1 gray
TEK48 8' (96")	2 black
TEK412 12' (144")	3 white

## Component Ordering Information (ordered separately)

1	2
Model	Finish*
TEK11 live end, left (standard)	1 gray
TEK12 live end, right (reverse)	2 black
TEK14 live center feed	3 white
TEK21* straight connector	*For use with TEKxx/ GES15 models.
TEK24 adjustable connector	
TEK34 L connector, feedable, adjustable universal polarity	
TEK38 X connector, feedable	
TEK39 T connector, feedable, adjustable right polarity	
TEK40 T connector, feedable, adjustable left polarity	
TEK41* dead end	
GES15 outlet box cover (for surface mount drywall only)	
SKB12-1** ceiling clamp (for cable & rod mounting, aluminum finish)	
XTSV12** bending tool (required to bend conductors to proper angle when track is field out)	
*Compatible with XTS, TEK & HTEK track.	
**Finish option not required for this option.	

## Mounting/Suspension Ordering Information (ordered separately, see page 4 for details)

1	2
Model	
<b>Clips</b>	<b>Canopy</b>
677-0897 T-grid clip, black, 9/16" Flat T (fixed suspension)	636-0001K plastic canopy, white
636-0600K T-grid clip, white, 9/16" Flat T (sliding suspension)	636-0076K plastic canopy, black
677-0801 T-grid clip, black, 15/16" Flat T (fixed suspension)	
636-0171K T-grid clip, white, 15/16" Flat T (sliding suspension)	<b>Stem Pendant Mounting (see pg 5 for details)</b>
636-0566K sliding suspension kit with cable gripper (A/C Cable not included)	701-0039* power feed suspension point
<b>Power Feed/Non-Power Feed (see pg 4 for details)</b>	701-0040* non-feed suspension point
636-0578 power feed metal canopy kit, white (includes aircraft cable; power feed cord ordered separately or by others)	701-0054* "L" (90°) connector suspension point
636-0579 power feed metal canopy kit, black (includes aircraft cable; power feed cord ordered separately or by others)	701-0055* "T" connector suspension point
636-0264 non-power feed metal canopy kit, black	701-0056* "X" connector suspension point
636-0268 non-power feed metal canopy kit, white	701-0025 stem/canopy kit, 12" stem, black texture
618-0029-10 12/5 SJT power feed cable, white, 10 ft	701-0026 stem/canopy kit, 12" stem, white texture
618-0029-20 12/5 SJT power feed cable, white, 20 ft	701-0050ST stem/canopy kit, 12" stem, silver texture (gray)
618-0032-10 12/5 SJT power feed cable, black, 10 ft	701-0027 stem/canopy kit, 18" stem, black texture
618-0032-20 12/5 SJT power feed cable, black, 20 ft	701-0028 stem/canopy kit, 18" stem, white texture
301-4366 aircraft cable suspension kit	701-0051ST stem/canopy kit, 18" stem silver texture (gray)
	701-0029 stem/canopy kit, 24" stem, black texture
	701-0030 stem/canopy kit, 24" stem, white texture
	701-0052ST stem/canopy kit, 24" stem silver texture (gray)
	701-0031 stem/canopy kit, 48" stem, black texture
	701-0032 stem/canopy kit, 48" stem, white texture
	701-0053ST stem/canopy kit, 48" stem, silver texture (gray)
	*Specify finish (-WT, -BT, -ST (gray))
	Consult factory for other T-Grid options

# TEK Global Track

2 Circuit/2 Neutral, 120V



PROJECT:

TYPE:

## Product Details

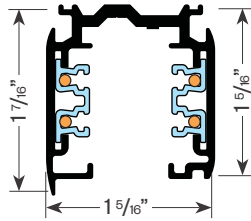

## TEK Track Components

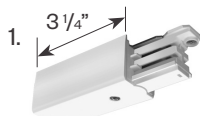

**TEK11** - Live End, left (standard)  
**TEK12** - Live End, right (reverse)  
(used for Conduit feed also)



**TEK21** - Straight Connector  
(Compatible with XTS, TEK & HTEK track)



**TEK14** - Live Center Feed



**TEK34** - L Connector, feedable  
(adjustable universal polarity)

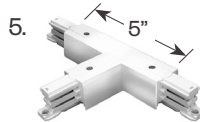

a. **TEK39** - T Connector, feedable  
(adjustable right polarity)  
b. **TEK40** - T Connector, feedable  
(adjustable left polarity)

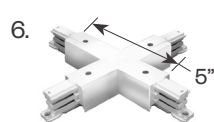

**TEK38** - X Connector, feedable



**TEK24** - Adjustable Connector



**TEK41** - Dead End  
(Compatible with XTS, TEK & HTEK track)

## TEK Track Configuration

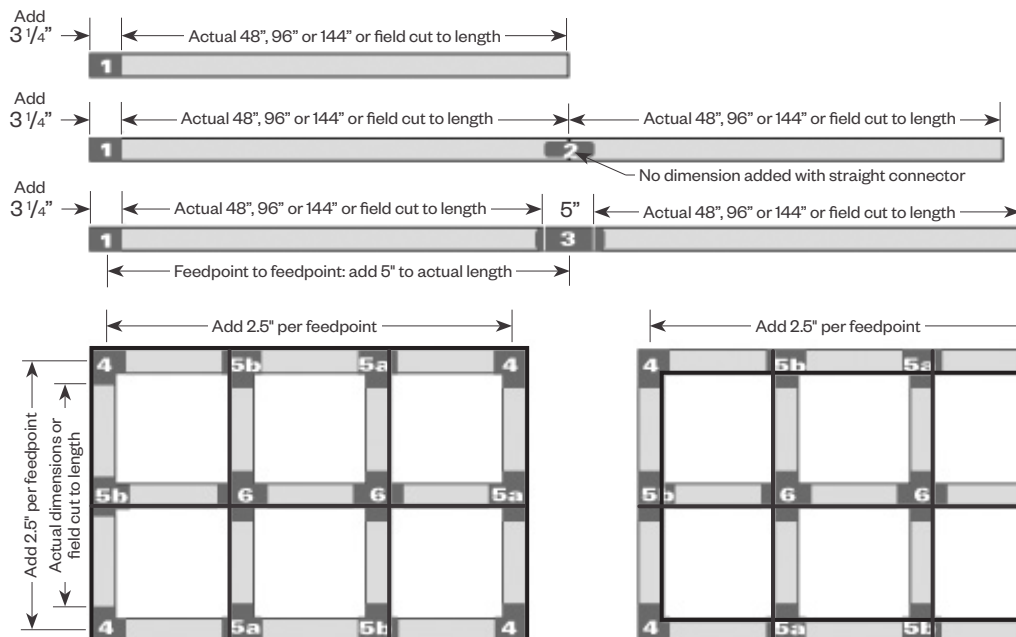

TEK track is polarized and manufactured with identifying ridges (shown as bold lines on diagrams). Refer to these diagrams to ensure proper connector selection.

# TEK Global Track

2 Circuit/2 Neutral, 120V



PROJECT:

TYPE:

## T-Grid Surface Mounting

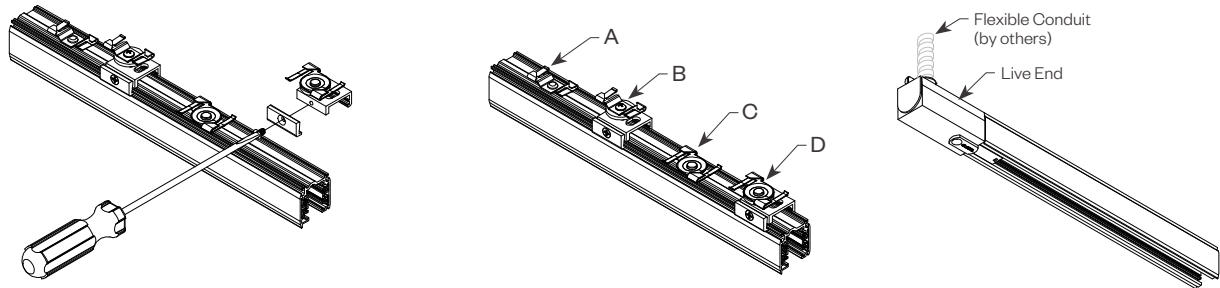

### T-GRID CLIPS:

**A: 677-0897** used for 9/16" Flat T  
(Fixed Suspension)

**B: 636-0600K** used for 9/16" Flat T Kit  
(Sliding Suspension)

**C: 677-0801** used for 15/16" Flat T  
(Fixed Suspension)

**D: 636-0171K** used for 15/16" Flat T Kit  
(Sliding Suspension)

Consult Factory for other T-Grid options

## Surface Mount (Drywall)

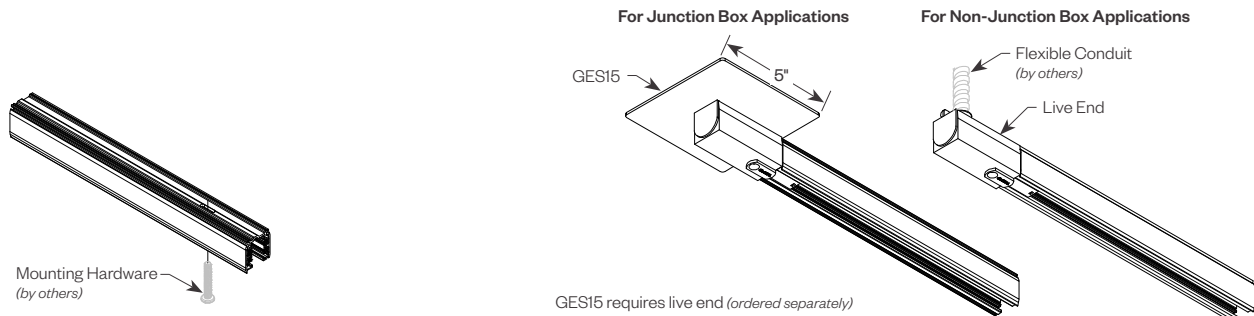

## Aircraft Cable Suspension

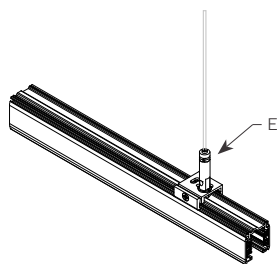

**E: TEK SLIDING SUSPENSION**  
636-0566K (Does not include aircraft cable)

**F: POWER FEED CANOPY KIT**  
636-0578 (white)  
636-0579 (black)

**G: NON-POWER FEED CANOPY KIT**  
636-0264 (black)  
636-0268 (white)

**H: POWER FEED CORD** (ordered separately)  
618-0029-XXX.XX (12/5 cord, white)  
618-0032-XXX.XX (12/5 cord, black)  
Example: 618-0029-120.00  
Power Feed Cable, White, 10' long

### NOTES:

1. 20' aircraft cable supplied with kits, except with 636-0566K
2. 12/5 power feed cord ordered separately or by others
3. 636-0566K is to be used in conjunction with canopy kits
4. Canopy kits require junction box for installation (by others)

### SKB12 with Gripper

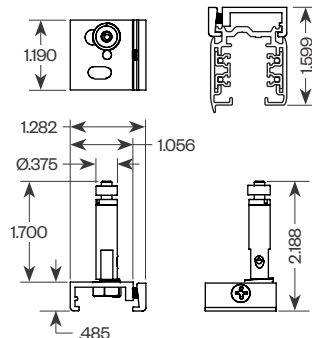

### Power Feed Canopy Kit

### Non-Power Feed Canopy Kit

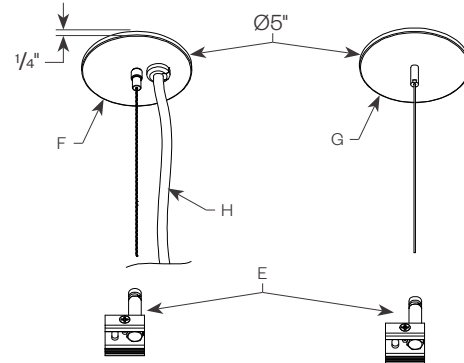

### Aircraft Cable Suspension Kit 301-4366

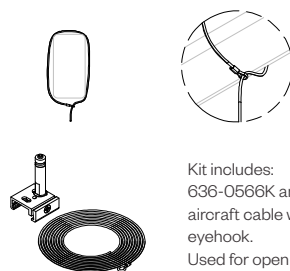

Kit includes:  
636-0566K and 20'  
aircraft cable with  
eyehook.  
Used for open ceiling  
suspension.

### Plastic Canopy Kit (ordered separately)

636-0001K (white)  
636-0076K (black)  
Ø2 1/2"

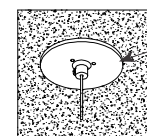

Canopy is to be  
used to cover a  
hole in a ceiling tile.

# TEK Global Track

2 Circuit/2 Neutral, 120V



PROJECT:

TYPE:

## Stem Mount Suspension

Stems are field cuttable

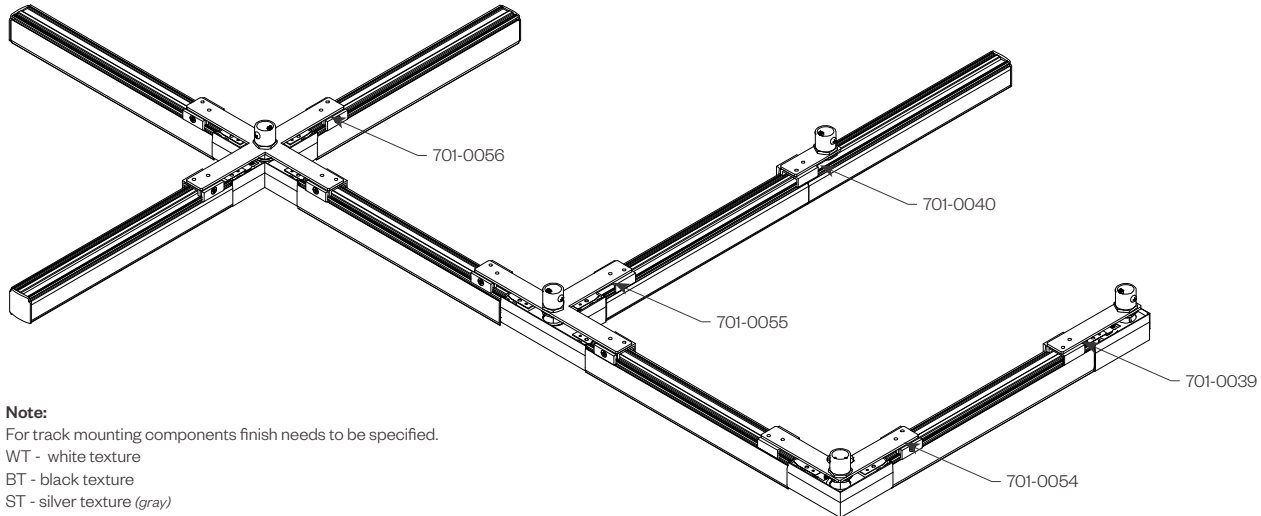

### Note:

For track mounting components finish needs to be specified.

WT - white texture

BT - black texture

ST - silver texture (gray)

Example:

701-0056-WT

### 3/8" STEM/CANOPY KIT:

Includes crossbar & hardware.

Available in 12", 18", 24" & 48" stem lengths.

Stems are field cuttable.

701-0025 - 12", black texture

701-0026 - 12", white texture

701-0050ST - 12" silver texture (gray)

701-0027 - 18", black texture

701-0028 - 18", white texture

701-0051ST - 18" silver texture (gray)

701-0029 - 24", black texture

701-0030 - 24", white texture

701-0052ST - 24" silver texture (gray)

701-0031 - 48", black texture

701-0032 - 48", white texture

701-0053ST - 48" silver texture (gray)

