

# Acion

## Small Wall-Mount LED Accent

WMACCS / BLK



### Features

The Amerlux Accent luminaire employs solid state technology and precision engineering to provide small scale LED solutions in landscape and architecture layouts. All components are encapsulated inside a single attractive enclosure designed for superior performance in weather resistant applications. Offered in a choice of beam spreads, finishes, and color temperatures, two mounting options and glare shield are also available.

### Product Overview

|               |                          |
|---------------|--------------------------|
| Wattage:      | 10W                      |
| Lumen Output: | 710 lm                   |
| Color Temp:   | 2,700K / 3,000K / 3,500K |
| Dimming:      | ELV at 120v only         |

### PROJECT:

### TYPE:

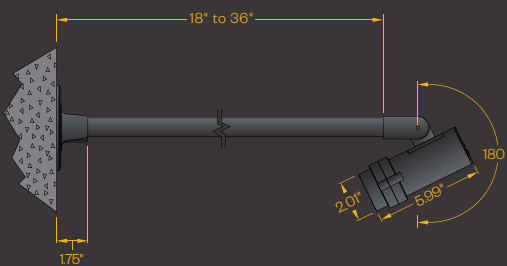

### Construction:

- Die-cast aluminum
- IP67 sealed optical chamber and integral driver chamber
- Easy “two-screw” integral driver access, does not disturb optical chamber seal
- Flush lens prevents puddles/water deposits in upward facing applications
- Knuckle mount
- Vertical aiming lock, with tamper-resistant tooled locking after final aiming

### Optics:

- Lumen maintenance: 70% @ 50,000 hours
- 10°, 15°, 30°, 40°, 60°, 60x10, 60x30, 90x60 beam spreads are available with secondary shaping lens

### Electrical:

Integral driver  
 Input voltage 120v-277v auto-sensing  
 1/2" NPSM wire entry  
 Drive current 700mA  
 Power consumption 10W  
 ELV dimmable at 120v only

**ETL listed, suitable for wet locations.**

### Optical Accessories:

- Hexell Louver (HCS)
- Half Glare Shield (HGS)

### Finish:

Premium quality thermoset polyester powdercoat for a durable finish.

**BLK** -Satin Black  
**CLB** -Classic Bronze

**GRN** -Green  
**CSTM** -Custom

**PROJECT:**

**TYPE:**

**Optical Accessories:**

**HGS**  
(Glare Shield)

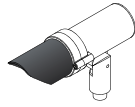

**HCS**  
(Hexell Louver)

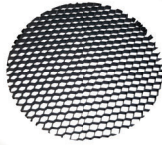

**Mounting Plate:**

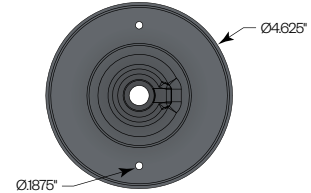

**Optical Performance:**

Polar Graph  
**ACCS / 27K / 10**

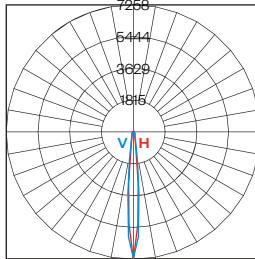

Maximum Candela = 7258  
Horizontal Beam Angle (50%) 11  
Vertical Beam Angle (50%) 11  
Horizontal Field Angle (10%) 21  
Vertical Field Angle (10%) 22

Polar Graph  
**ACCS / 27K / 30**

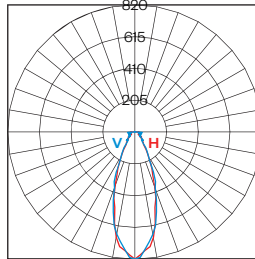

Maximum Candela = 820  
Horizontal Beam Angle (50%) 38  
Vertical Beam Angle (50%) 36  
Horizontal Field Angle (10%) 77  
Vertical Field Angle (10%) 76

Polar Graph  
**ACCS / 27K / 40**

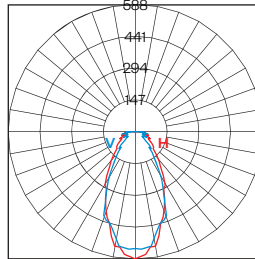

Maximum Candela = 588  
Horizontal Beam Angle (50%) 47  
Vertical Beam Angle (50%) 46  
Horizontal Field Angle (10%) 130  
Vertical Field Angle (10%) 130

Polar Graph  
**ACCS / 27K / 60**

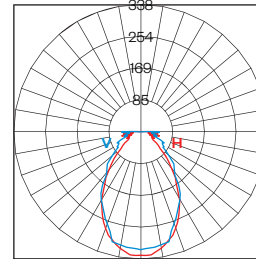

Maximum Candela = 338  
Horizontal Beam Angle (50%) 70  
Vertical Beam Angle (50%) 66  
Horizontal Field Angle (10%) 148  
Vertical Field Angle (10%) 142

Polar Graph  
**ACCS / 27K / 60X10**

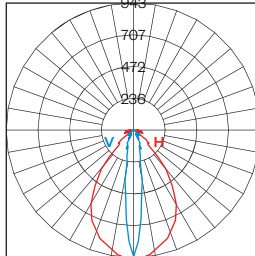

Maximum Candela = 943  
Horizontal Beam Angle (50%) 66  
Vertical Beam Angle (50%) 18  
Horizontal Field Angle (10%) 98  
Vertical Field Angle (10%) 52

Polar Graph  
**ACCS / 27K / 60X30**

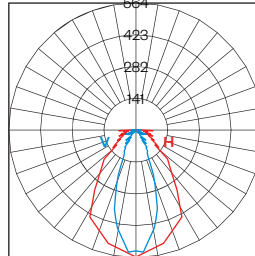

Maximum Candela = 564  
Horizontal Beam Angle (50%) 65  
Vertical Beam Angle (50%) 35  
Horizontal Field Angle (10%) 115  
Vertical Field Angle (10%) 99

Polar Graph  
**ACCS / 27K / 90X60**

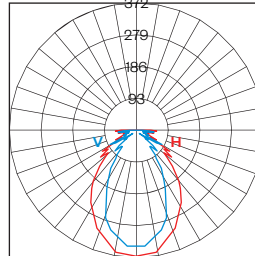

Maximum Candela = 372  
Horizontal Beam Angle (50%) 78  
Vertical Beam Angle (50%) 56  
Horizontal Field Angle (10%) 152  
Vertical Field Angle (10%) 142

Data represents the use of light shaping filters  
Complete photometric data (ies format) available upon request

**Ordering Information**

| Model         | CCT  | Beam Spread          | Approx. Lumens       | Total Efficacy       | Mounting   | Finish             | Optical Accessories                                   | Arm Length               |  |            |
|---------------|--|----------------------|----------------------|----------------------|------------|--------------------|---|--------------------------|--|------------|
| <b>WMACCS</b> | <b>27 (2,700K)</b><br><b>30 (3,000K)</b><br><b>35 (3,500K)</b> | Symmetric Pattern    | <b>10 (10°)</b>      | 630-710              | 63-71 lm/W | <b>K (Knuckle)</b> | <b>BLK</b><br><b>CLB</b><br><b>GRN</b><br><b>CSTM</b> | <b>HCS</b><br><b>HGS</b> | <b>18"</b><br><b>24"</b><br><b>36"</b> |            |
|               |  |                      | <b>15 (15°)</b>      | 600-680              | 60-68 lm/W |                    |   |                          |  |            |
|               |  |                      | <b>30 (30°)</b>      | 570-650              | 57-65 lm/W |                    |   |                          |  |            |
|               |  |                      | <b>40 (40°)</b>      | 570-650              | 57-65 lm/W |                    |   |                          |  |            |
|               |  |                      | <b>60 (60°)</b>      | 540-620              | 54-62 lm/W |                    |   |                          |  |            |
|               |  | Horizontal Pattern   | <b>H6010 (60x10)</b> | 630-570              | 63-57 lm/W |                    |   |                          |  |            |
|               |  |                      | <b>H6030 (60x30)</b> | 570-590              | 57-59 lm/W |                    |   |                          |  |            |
|               |  |                      | <b>H9060 (90x60)</b> | 580-610              | 58-61 lm/W |                    |   |                          |  |            |
|               |  |                      | Vertical Pattern     | <b>V6010 (60x10)</b> | 630-570    |                    |   |                          |  | 63-57 lm/W |
|               |  |                      |                      | <b>V6030 (60x30)</b> | 570-590    |                    |   |                          |  | 57-59 lm/W |
|               |  | <b>V9060 (90x60)</b> | 580-610              | 58-61 lm/W           |            |                    |   |                          |  |            |

Ordering options shown as **BOLD**. Example: **WMACCS/30/10/K/BLK**